

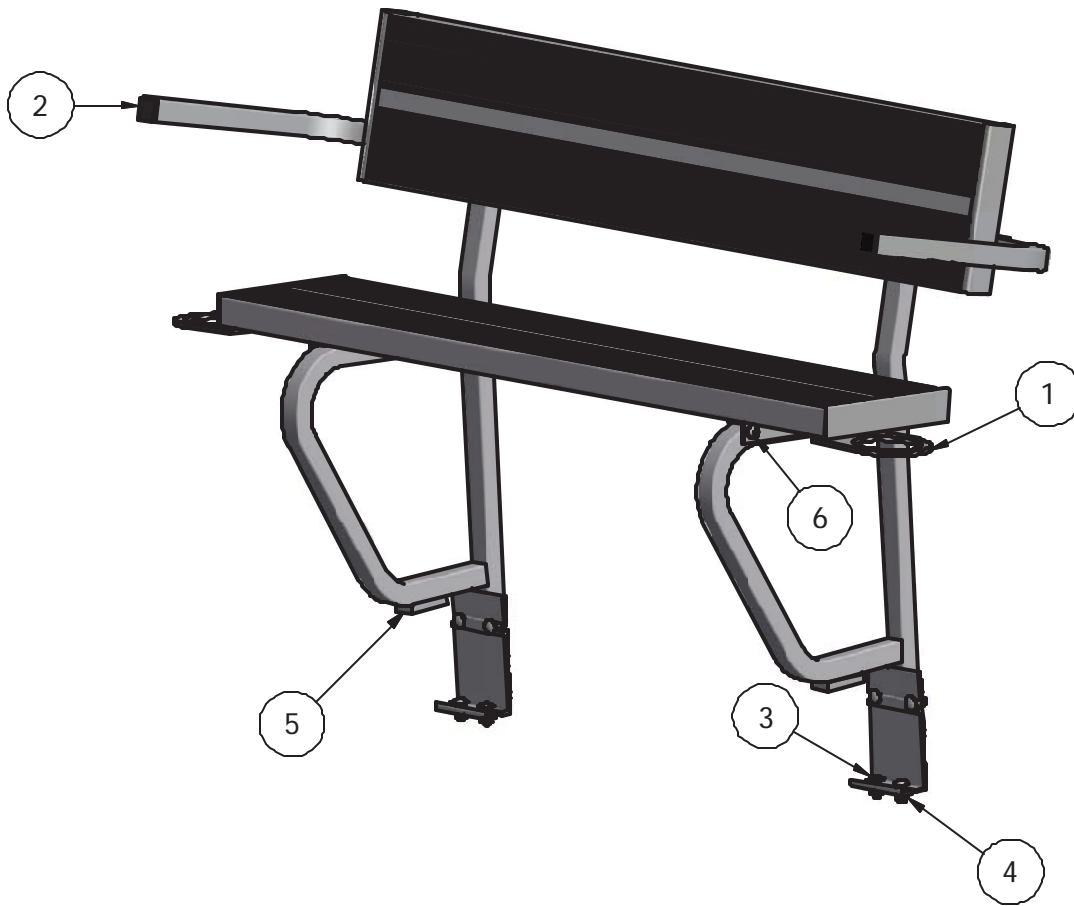

Aluminum Bench



PARTS LIST			
ITEM	QTY	PART NUMBER	DESCRIPTION
1	1	VM-179-04	BENCH PLANK CUP HOLDER
2	4	HD-00112	1 1/2" SQUARE CAP PLUG
3	8	HD-00059	3/8 x 1" CB (S/S)
4	8	HD-00056	3/8 FLANGE NUT (BRASS)
5	2	VM-179-07	DECK SHIM
6	8	HD-00174	#10-1 x 1" SELF TAP SCREW (S/S)
7	2	HD-00094	1/4-20 x 1 3/4 HCS (S/S)
8	2	HD-00095	ACORN NUT 1/4" (S/S)

3

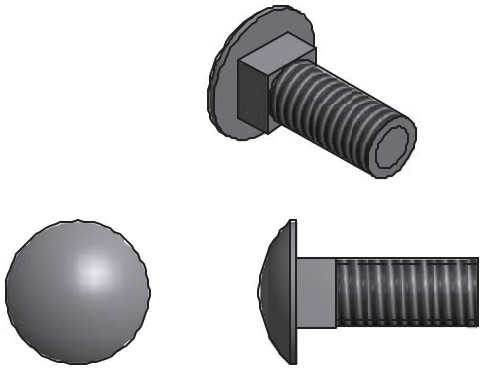

3/8 X 1 S.S. CARRIAGE BOLT (8 REQ'D)

4

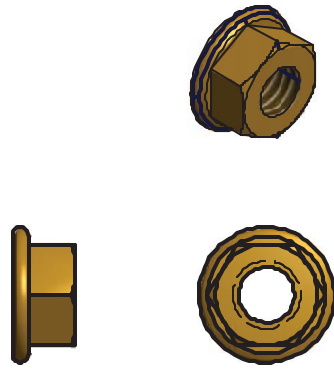

3/8 FLANGE NUT BRASS (8 REQ'D)

6

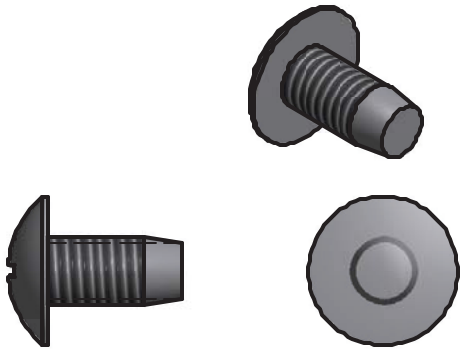

#10-1 X 1" SELFTAP SCREW S/S (12 REQ'D)

2

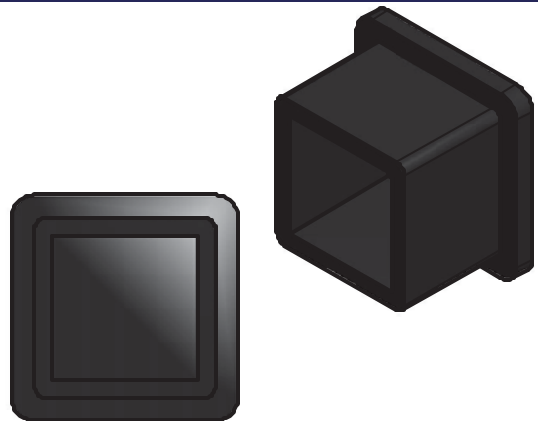

1 1/2" CAP PLUG (4 REQ'D)

1

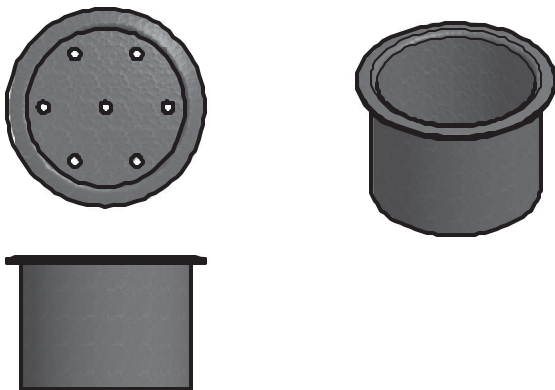

4" CUP HOLDER (2 REQ'D)

7

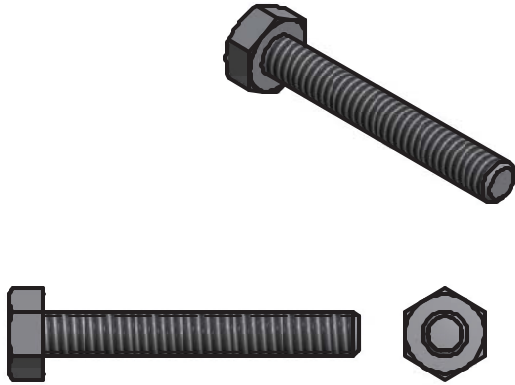

1/4-20 X 1 3/4 HCS BOLTS S/S (2 REQ'D)

8

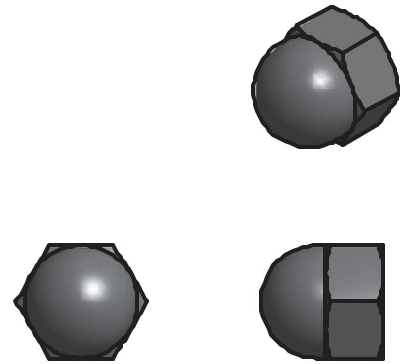

1/4" ACORN NUT S/S (2 REQ'D)

5

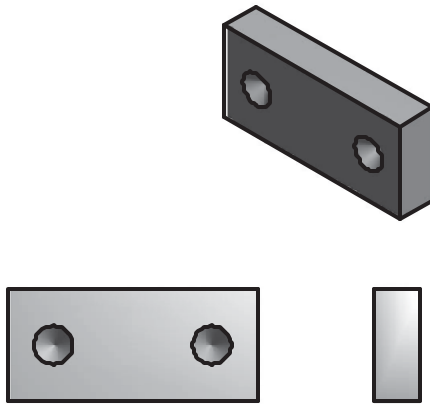

DECK SHIM (PLASTIC) (2 REQ'D)

To insure your safety while assembling your Voyager product:

- Fully read and understand the assembly instructions
- Do not assemble this product if items are missing or damaged
- Wear protective gloves, clothing and eye wear when assembling this product
- For ease of assembly best to have 2 people
- Check tightness of all hardware each year to avoid injury.

Installation procedure

The following tools will be needed: tape measure, (1) 9/16" wrenches, (2) 7/16" wrenches, Phillips screw driver.

1. Insert head of 4 carriage bolts into raceway on the underside of the rail and slide to desired location on dock. **Per diagram A.**
2. Install 1 ¼" caps into the top of bench leg frames. **Per diagram B.**
3. If using on dock with Titan X-series decking skip to line 6. If used on dock with Titan Classic deck, or similar height deck, a shim will need to be attached to bottom of the bench legs.
4. Set bench leg upside down and attach shim with self drilling screws to leg. **Per diagram C.**
5. Repeat step 4 for second bench leg.
6. Hook first bench leg into side of dock rail at desired location and slide carriage bolts into bracket. Finger tighten nuts at this time. **Per diagram D**
7. Repeat step 3 for second bench leg, leaving approximately 31" in between bench legs. **Per diagram E.**
8. Once bench is in desired location put carriage bolt into raceway on the side of dock, slide carriage bolt into bench bracket and install flange nut. **Per diagram F.**
9. Repeat step 5 for remaining 3 carriage bolts.
10. Set seat plank onto bench legs, slide plank over until 1 side is up against bench leg. Position about 2" out from leg. **Per diagram G.**
11. Use 2 self tapping screws and attach to leg. **Per diagram G-1.**
12. Slide 2nd leg out to angle on seat plank and repeat step 8.
13. Take seat back and hold flush with top of bench leg, attach 1st side with 2 self tapping screws. **Per diagram H.**
14. Repeat step 10 to attach 2nd side.
15. Install first armrest into tube on seat back and install ¼" x 1-3/4" hex bolt with acorn nut. **Per diagram I.**

16. Repeat step 12 for second armrest.
17. Use 7/16" wrenches to tighten armrest bolts.
18. Install caps into end of armrest tubes. **Per diagram J.**
19. Use 9/16" wrench to tighten all 8 mounting bolts (carriage bolts).
20. Set plastic cup holders into plates on seat plank. **Per diagram K.**
21. Check tightness of hardware each year to avoid injury.

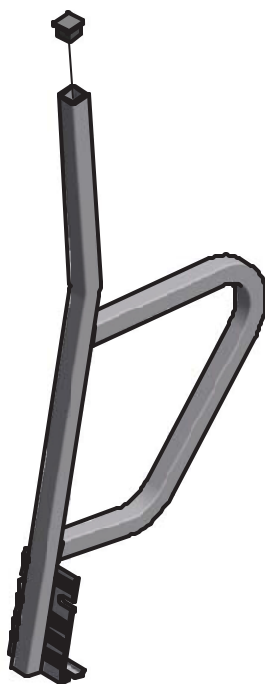
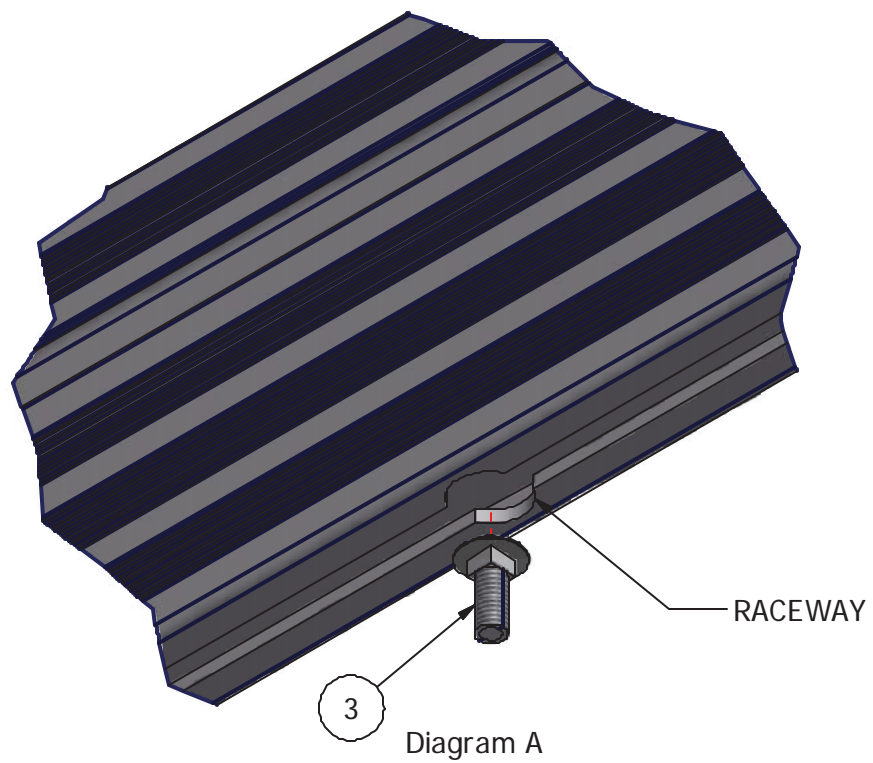

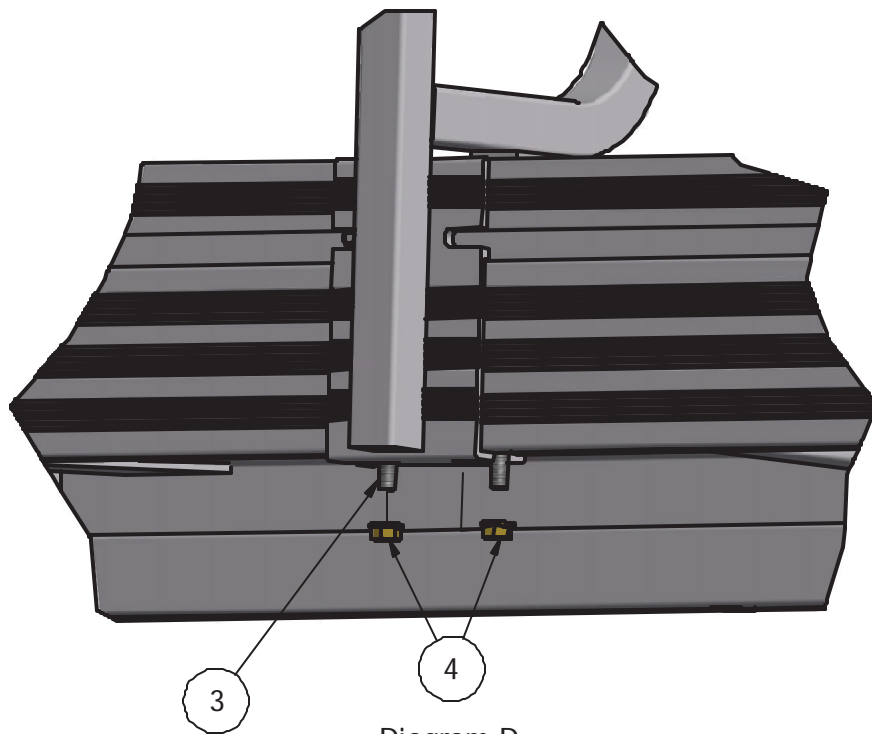
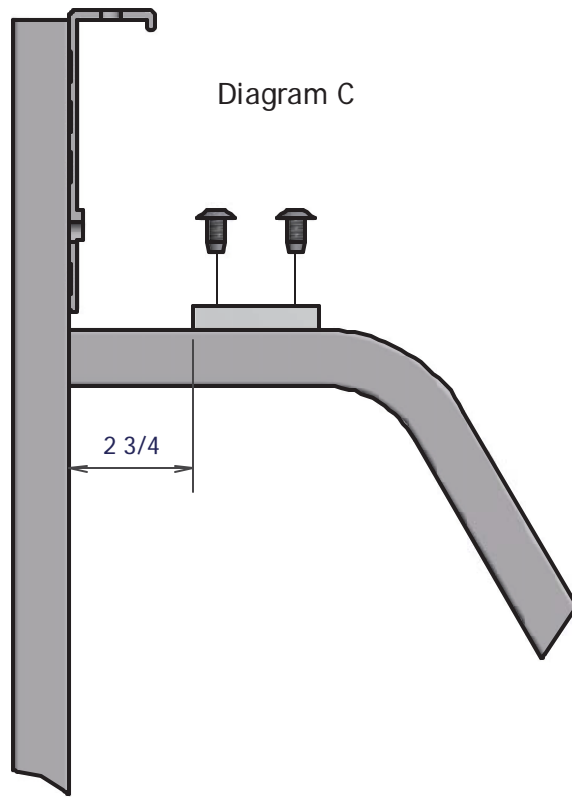

Diagram D

