

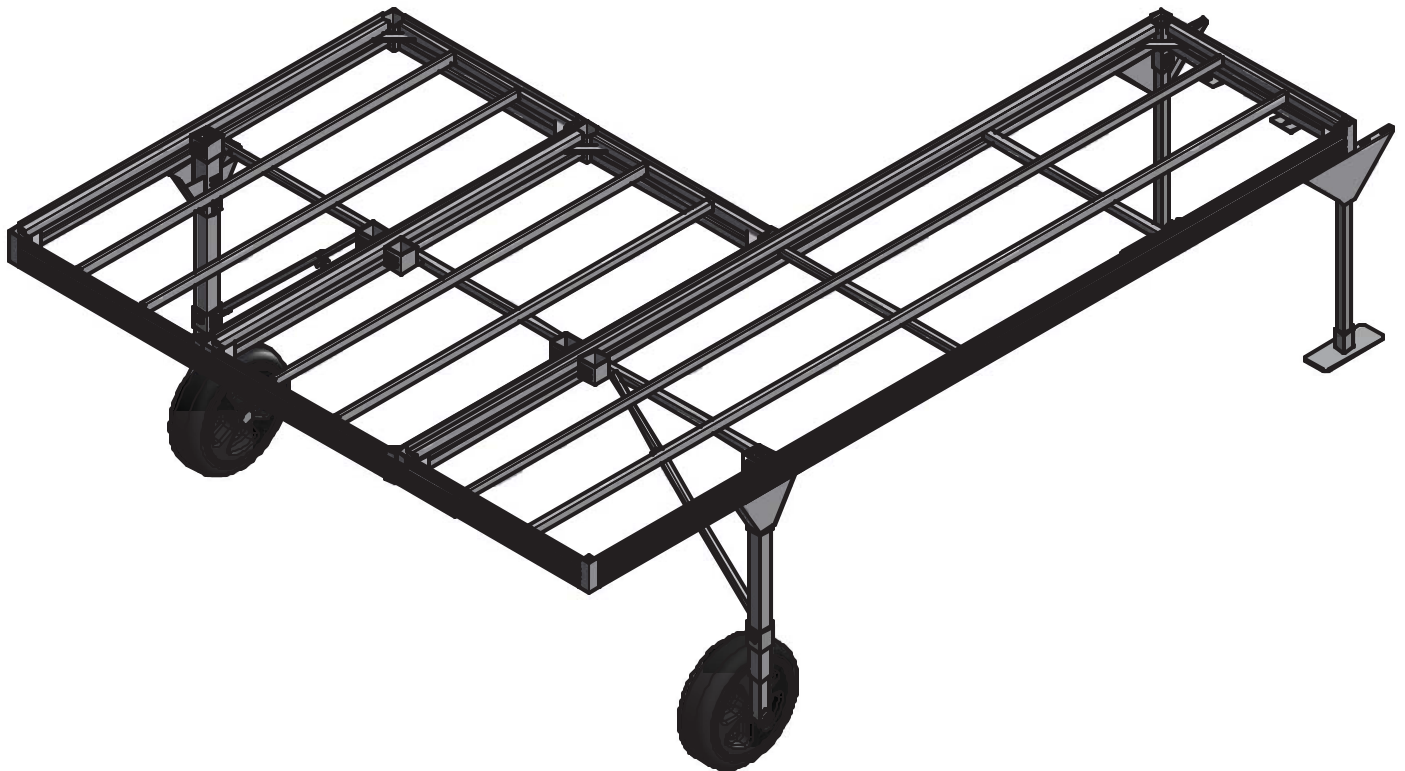

Roll In W/ Double L

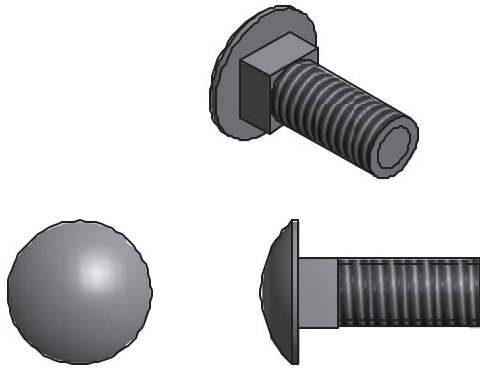

1



3/8 X 1 CARRIAGE BOLT SS

2

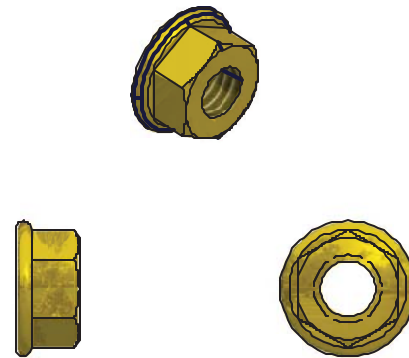

3/8 FLANGE NUT BRASS

3

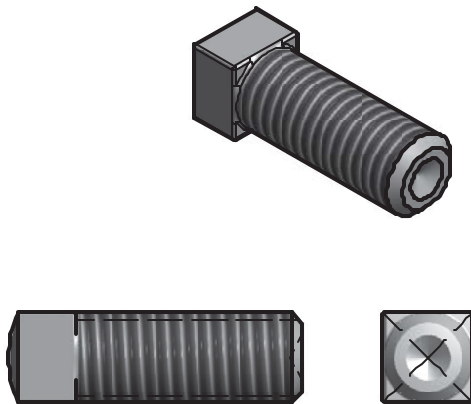

1/2-13 X 1.25 SQ BOLT SS

4

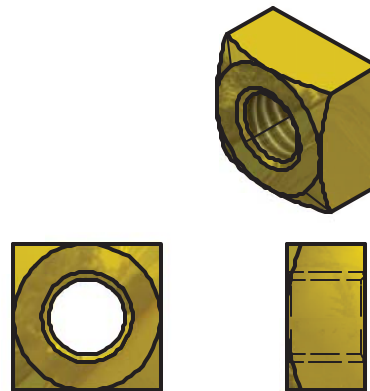

1/2 SQ NUT BRASS

5

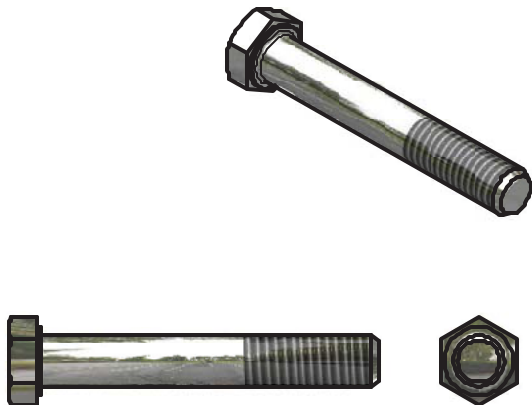

3/8 -16 X 2.5" BOLT SS

6

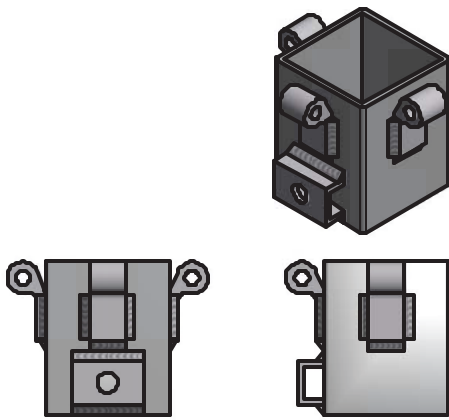

BRACE BRKT

7

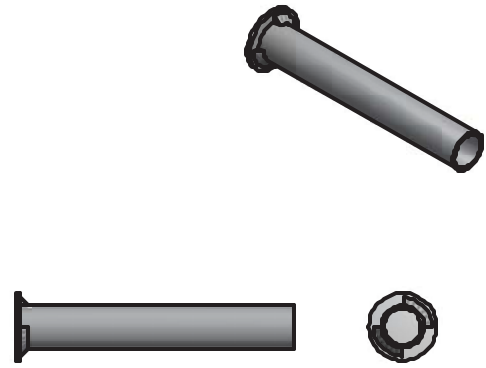

SINGLE AXLE TUBE

8

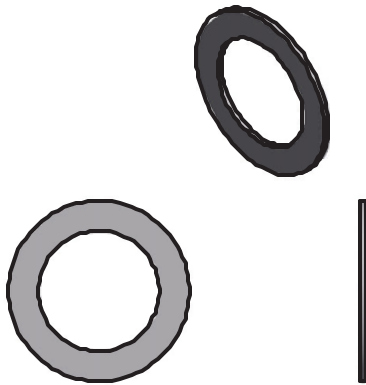

3" AXLE WASHER SS

9

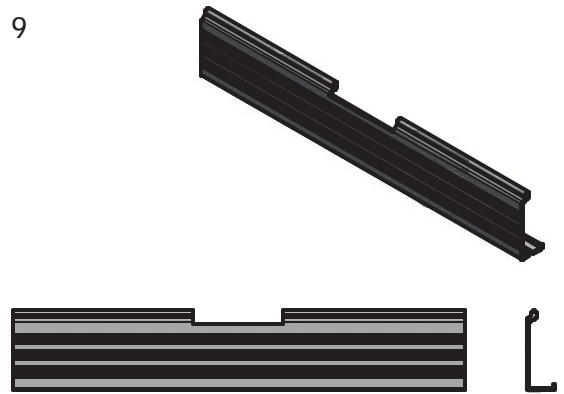

30 in CONNECTOR W-LIP

10

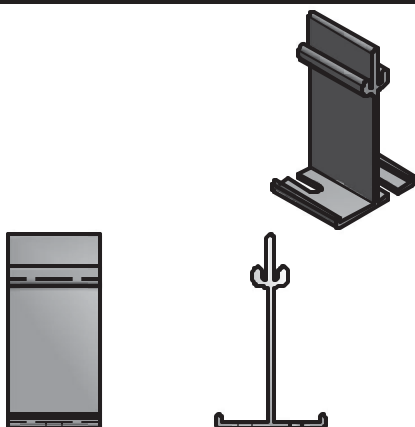

3 Y CONNECTOR ALUMINUM

11

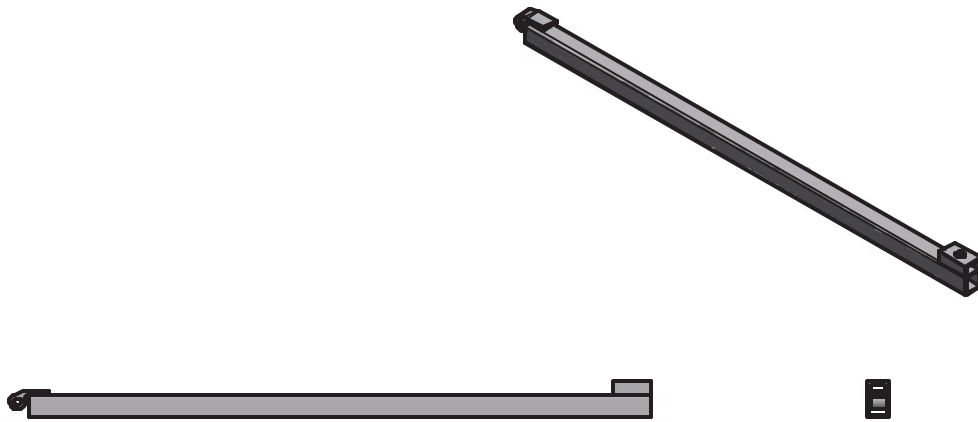

UPPER BRACE XMNT

12

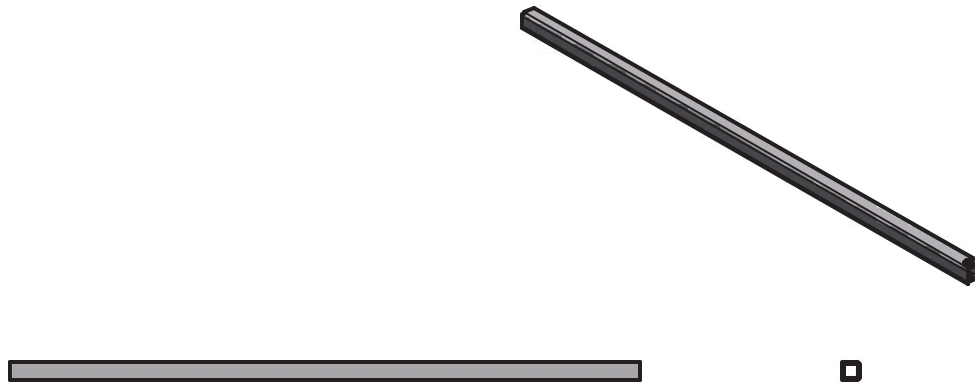

LOWER LEG BRACE

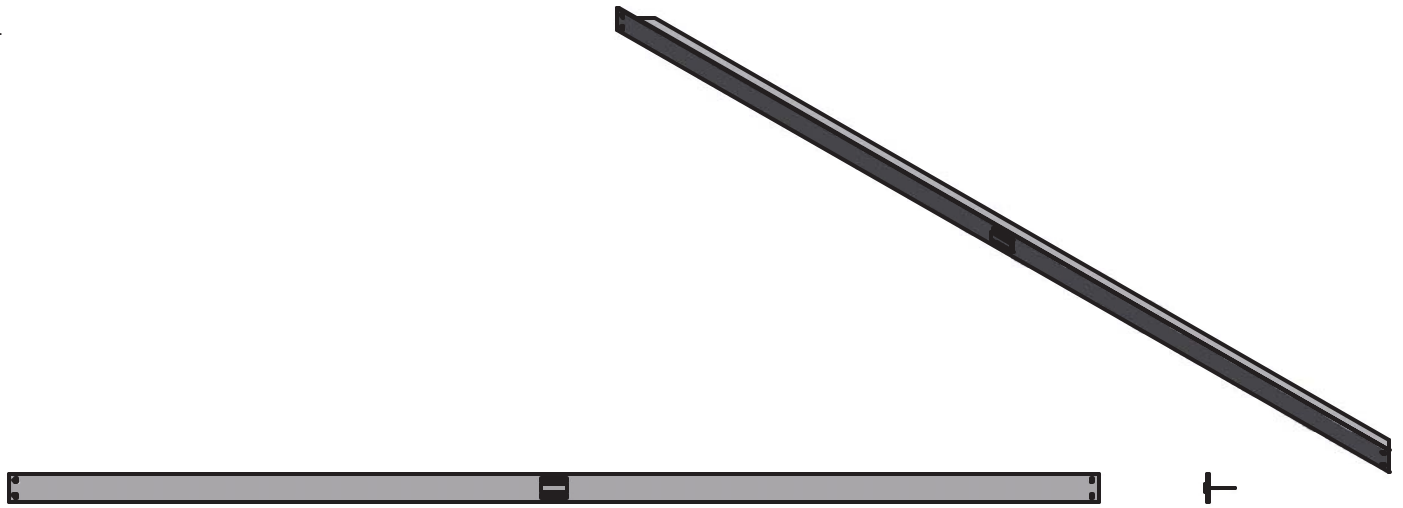

10' T-BRACE

NOTE:
ONLY USED ON 5' WIDE WITH 5' L, BOLT INCLUDED WITH T- BRACE.(10' VM-064)
4' WIDE WITH 4' L HARDWARE INCLUDED WITH DOUBLE L KIT.(12' VM-067)
5' WIDE WITH 5' L HARDWARE INCLUDED WITH DOUBLE L KIT.(15' VM-071)

INSTRUCTIONS FOR DOCKS MODELS 2010 and newer

To insure your safety while assembling your Voyager roll in dock:

- Fully read and understand the assembly instructions
- Do not assemble this product if items are missing or damaged
- Wear protective gloves, clothing and eye wear when assembling this product
- For best results find a flat area with plenty of room to assemble the dock

Before assembly you will need to determine your dock layout and water depths. Once layout is figured out, take water depth measurements where dock will be located. Take measurements at point of every dock section joint (the distance apart to measure will depend on dock lengths used and layout). Make sure length of dock leg will compensate for distance dock is out of the water and also water fluctuation. You will need to decide if add-on legs are going to be flush with bottom of decking or if leg will stick above decking and how much.

❖ *Note: You may need assistance when turning dock over and also when installing dock into the water.*

The following tools will be needed: 2-1/2" wrenches, 2- 9/16" wrenches, tape measure, level, marking utensil, cut off saw and 15/16" socket with ratchet or wrench

- 1) For ease of assembly lay a 16' dock frame and 8' frames for L's upside down on a flat surface (have end that will be out the farthest in lake facing in direction to be rolled out in) according to desired design layout of L's. Using tape measure make sure to measure from Lake End of L to large leg pocket welded in dock frame so it is positioned the same as the 16'. **Per diagram A-2, page 8.**
- 2) Slide 3 carriage bolts into raceway in bottom of dock rails on the 16' and 8' frames (3 on each frame) in the side rails that meet each other, sliding 1 towards each end and leave on in about center of 8'. **Per diagram E, page 9.**
- 3) Take 3 Y- connectors and hook into dock rails 1 in from each end and 1 in center of 8', slide carriage bolts into slots on connectors and put flange nuts on finger tight. **Per diagram E-1, page 10.**
- 4) Hook 8' up to 16' connecting with carriage bolt like in step 3.
- 5) Put 2 carriage bolts into bottom raceway of end rail on 16' & 1 in on the 8', slide bolts in towards connection 2-3" in from edge of end rail, second bolt can stay close to middle for now. **Per diagram E-2, page 10.**

LAKE END

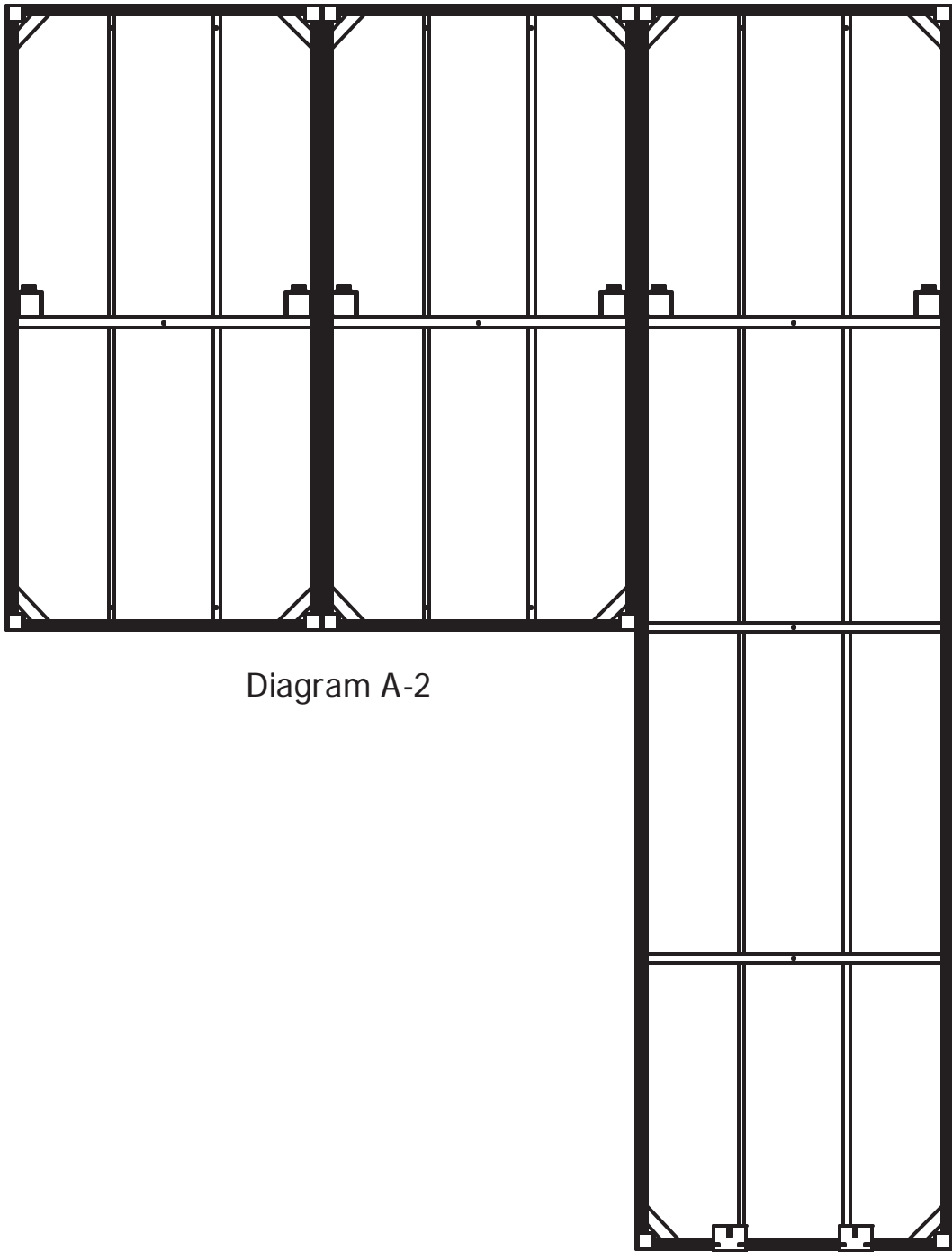
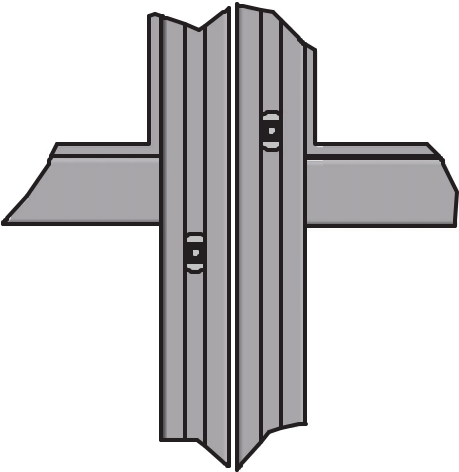

Diagram A-2

Diagram E



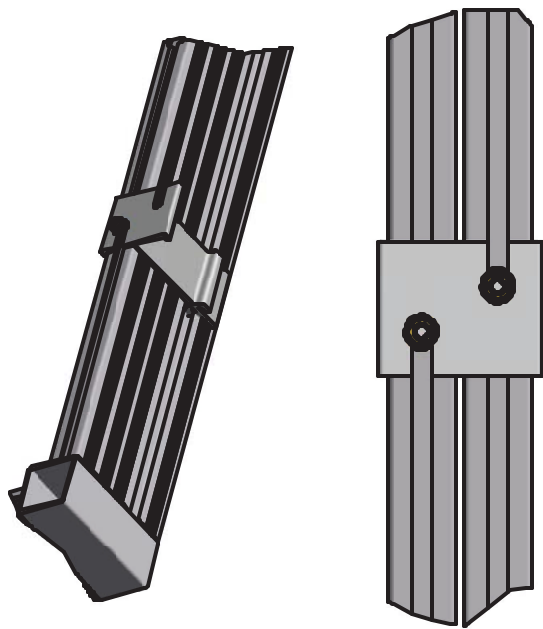

Diagram E-1

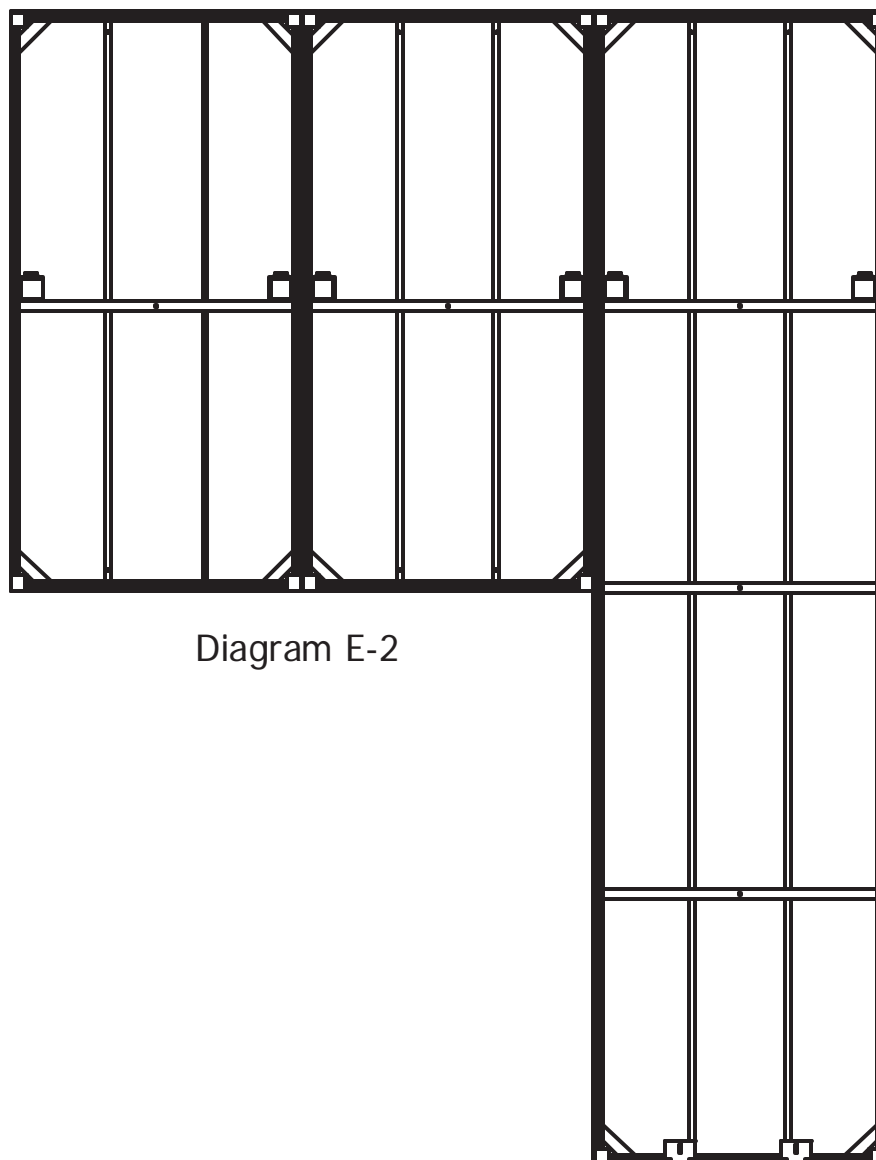

Diagram E-2

- 6) Install 30" connector over ends of dock frames, line carriage bolts up with slots as putting on, once on slide other 2 carriage bolts into slots and put all 4 flange nuts on finger tight at this point. **Per diagram F, page 12.**
- 7) Make sure side of dock rails on both frames are even and use 9/16" wrench to tighten flange nuts on 3-Y connectors and 30" connector. **Per diagram F-1, page 12.**
- 8) Repeat steps 2-7 for second L section.
- 9) Slide 2 carriage bolts into bottom raceway of dock rail in each of the 3 frames hooking together where joined together, put about 6" off center (towards shore end). **Per diagram G, page 13.**
- 10) Slide 2 carriage bolts into bottom raceway of dock rail of the outer dock frames, in opposite dock rail used in step 8, put about 6" off center (towards shore end). **Per diagram G-1, page 13.**
- 11) Start tee brace onto carriage bolts installed in steps 8-9 and position tee brace 6" off center (towards shore). Start flange nuts on carriage bolts. Using 9/16" wrench tighten center flange nuts first, then tighten outside one (this will put some tension on the T-brace). **Per diagram G-2, page 14.**
- 12) Repeat steps 9-11 for second t-brace, position 6" off center towards Lake End of dock. **Per diagram G-2-2, page 15.**
- 13) Install 2 carriage bolts into bottom raceway of side rail. One 10-12 inches on each side of large welded in leg socket. **Per diagram B, page 16.**
- 14) Install post reinforcement assembly into dock leg socket on outside rail. Slide carriage bolts into slots on post reinforcement brackets and install flange nuts. **Per diagram B-1, page 16.**
- 15) Tighten carriage bolts on post reinforcement assembly up with 9/16" wrench.
- 16) Install square nuts into channels on post reinforcement assembly and turn set bolt in far enough to keep in place for now. **Per diagram B-2, page 17.**
- 17) Install square nut into channel on dock leg socket and screw set bolt in. **Per diagram B-3, page 17.**
- 18) Tighten set bolt on dock leg socket only with ½" wrench. **Per diagram B-4, page 18.**
- 19) Slide screw leg into post reinforcement assembly to desired height* (dock may have to be blocked up in order for leg to be installed to proper height). **Per diagram B-5-1, page 18.**
- 20) With ½" wrench tighten up set bolts for screw leg at this time.
- 21) Install brace bracket onto bottom of screw leg (with channel and single hinge facing inside of dock). Install square nut into channel and turn set screw into it. Position bracket at bottom of large tube of screw leg and finger tighten set screw at this time. **Per diagram B-5-2, page 19.**

Diagram F

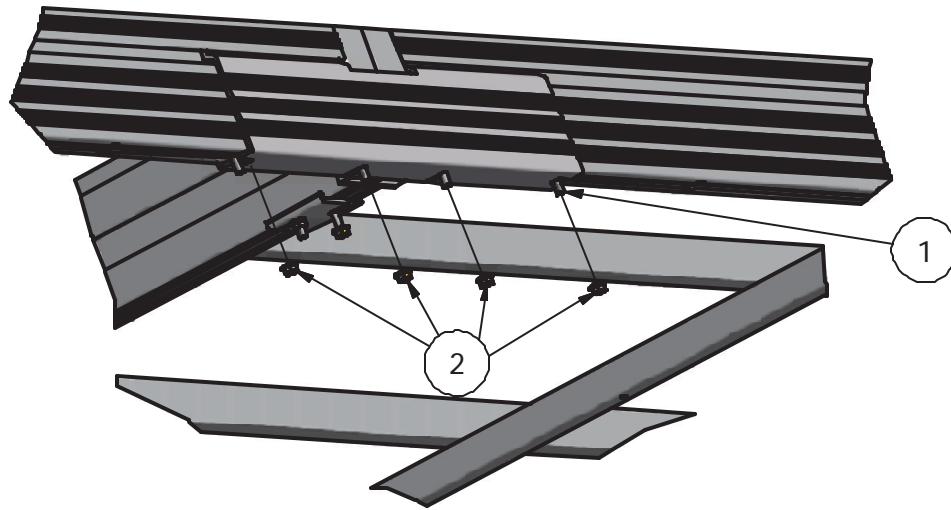

Diagram F-1

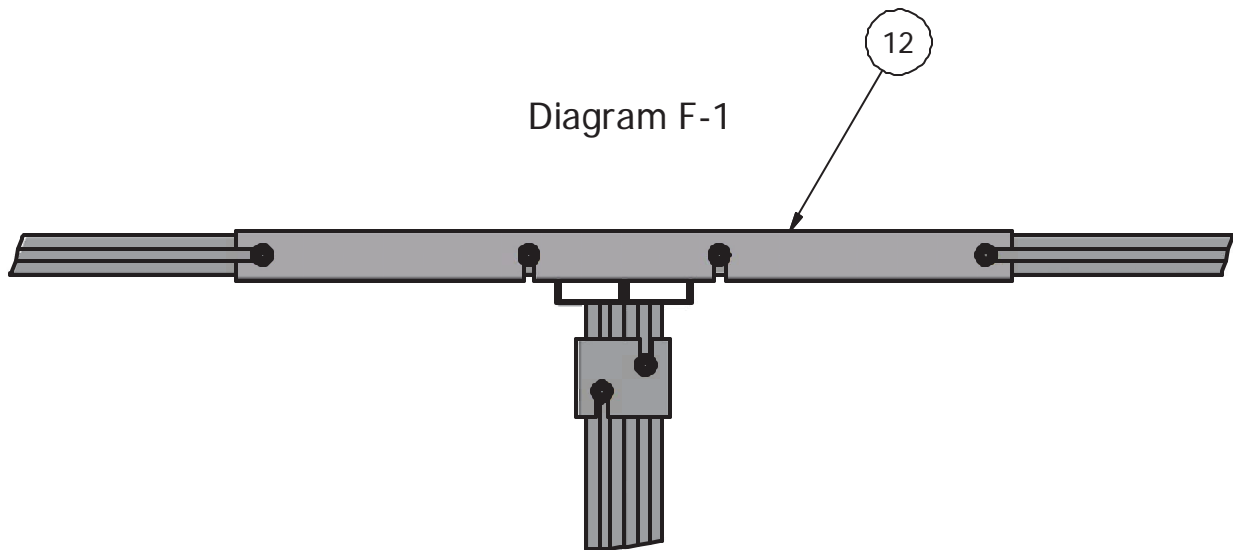

Diagram G

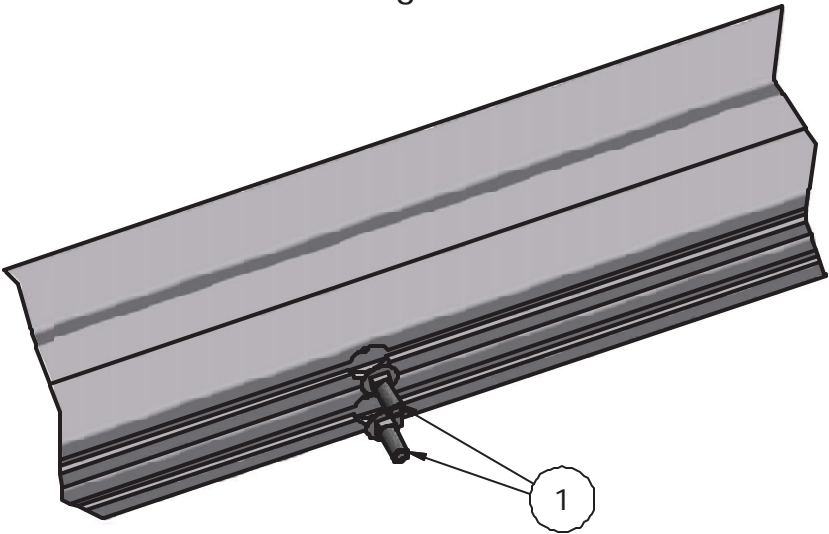

Diagram G-1

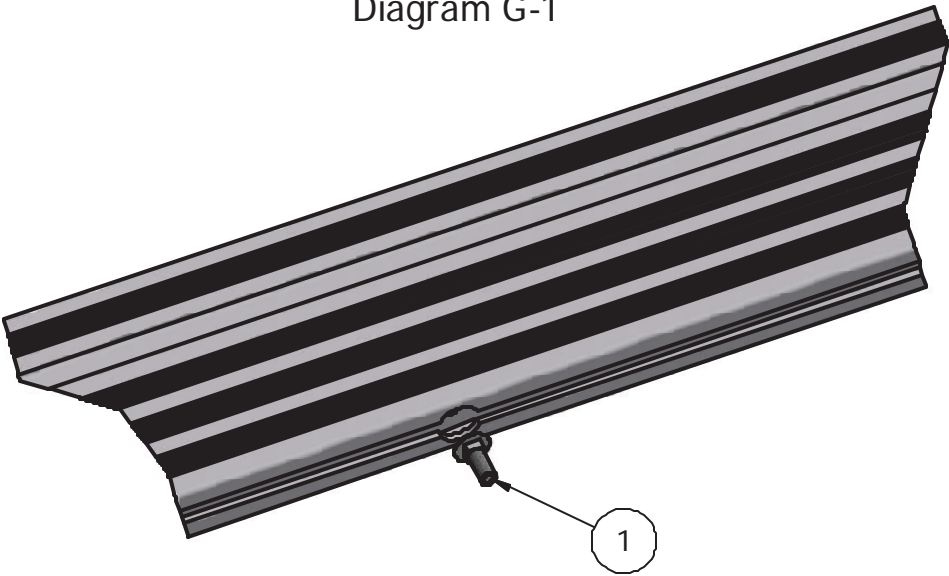

Diagram G-2

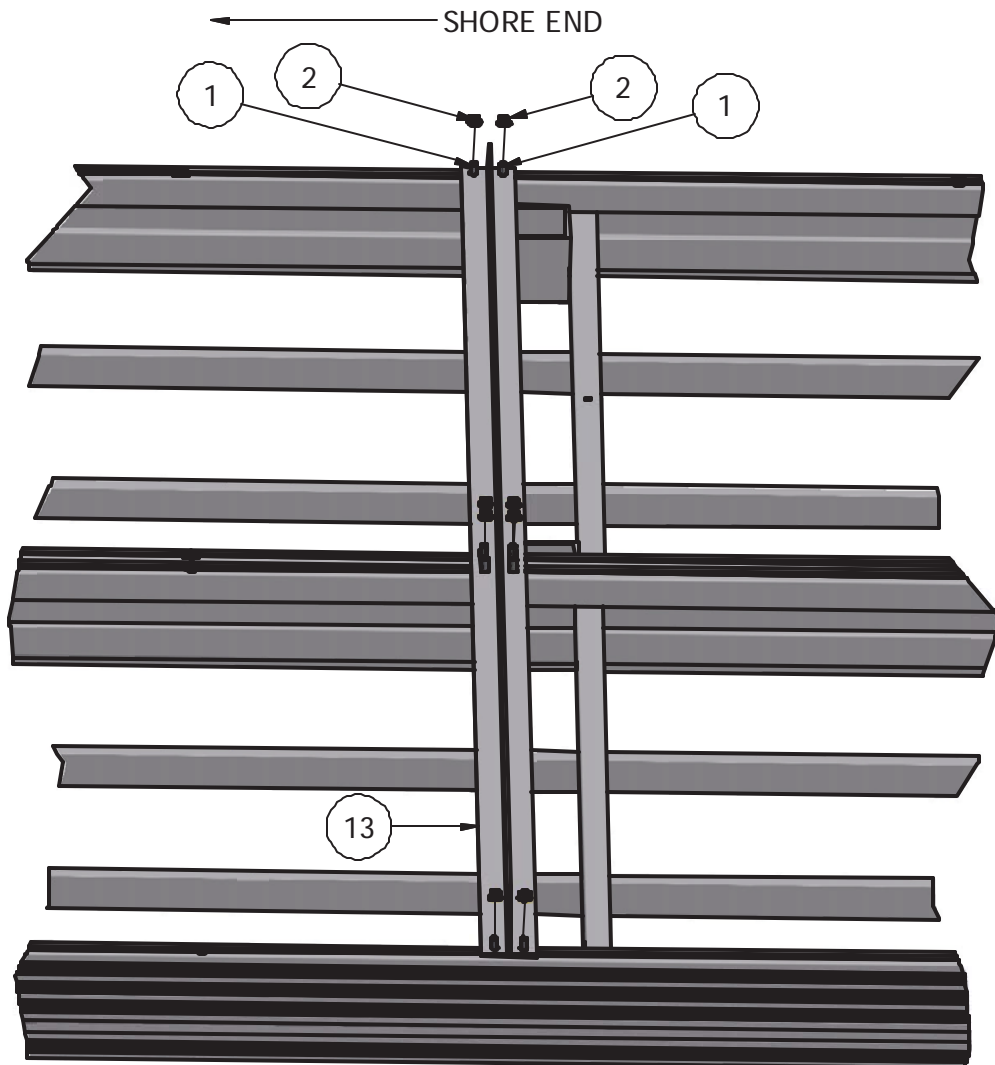
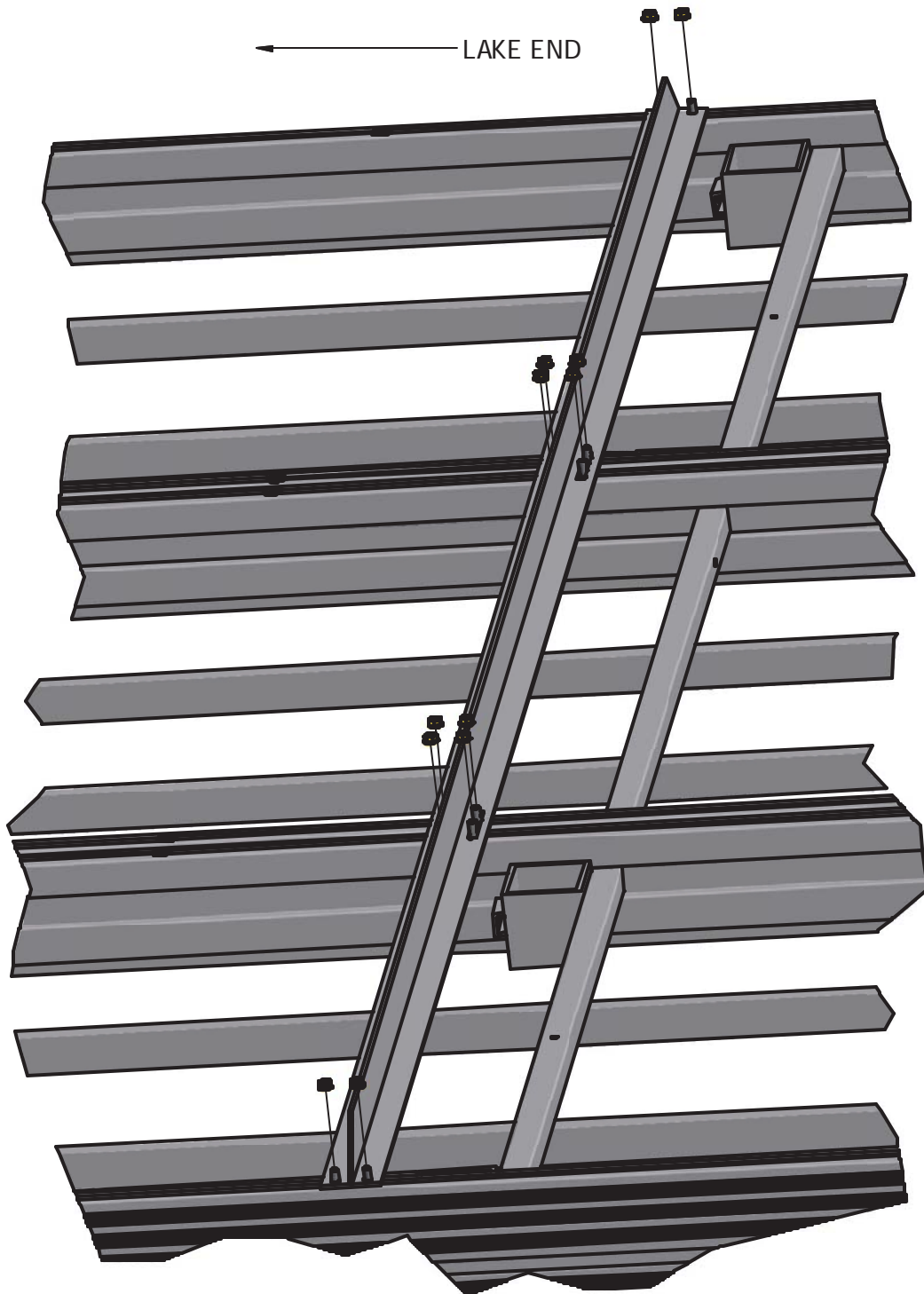

Diagram G-2-2



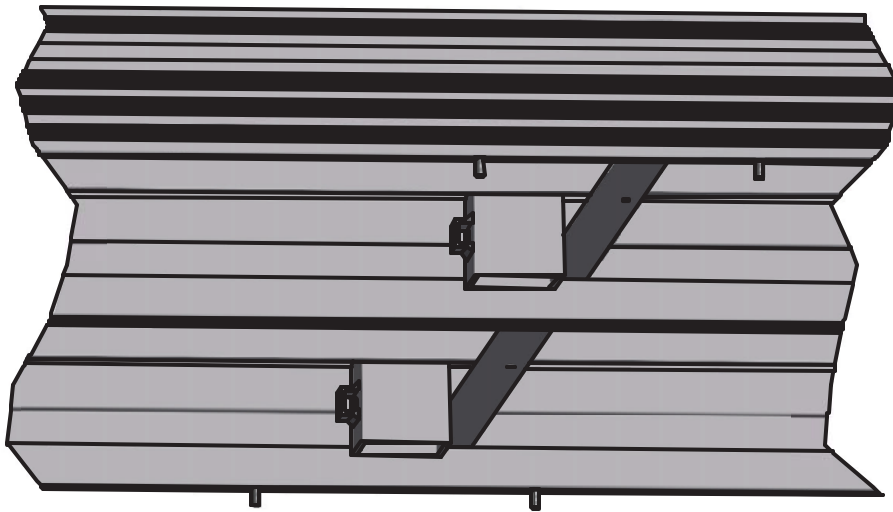

Diagram B

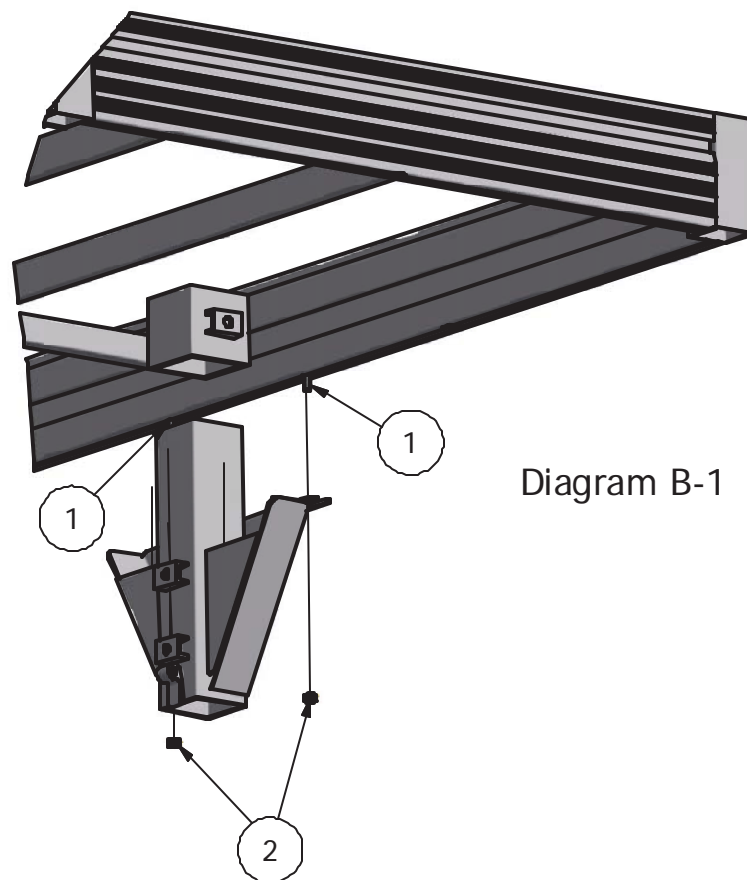
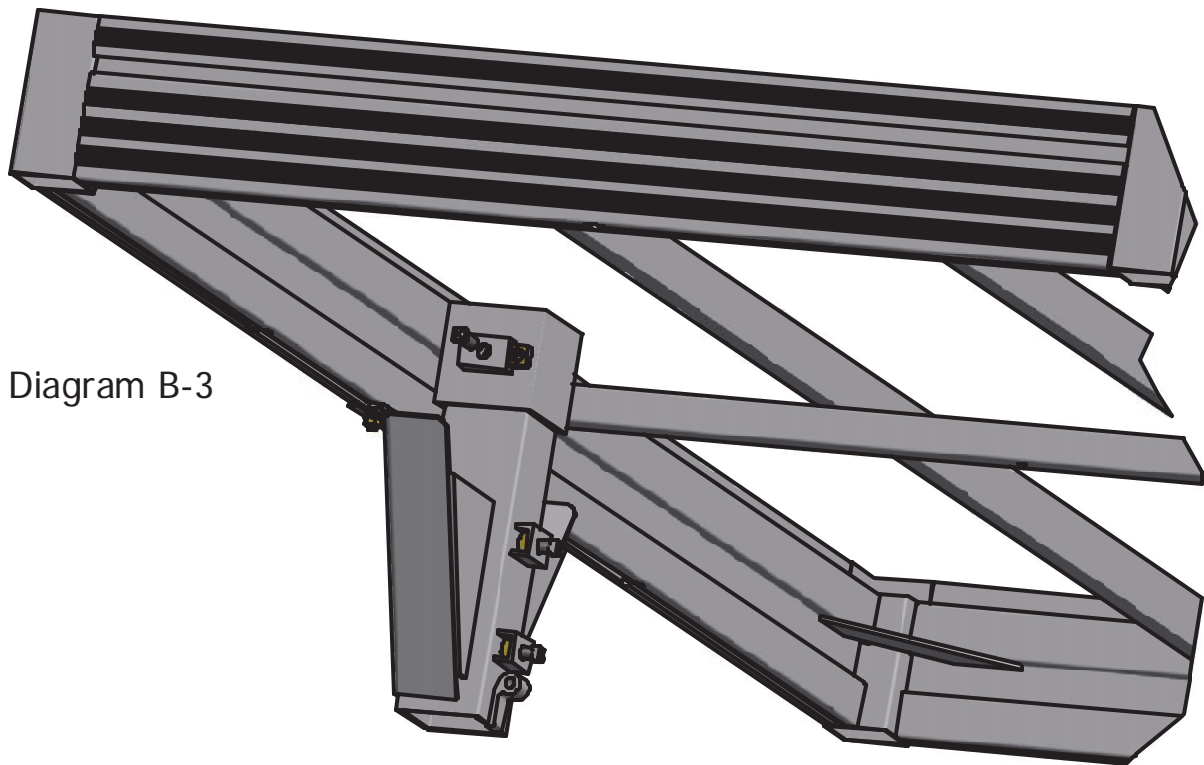
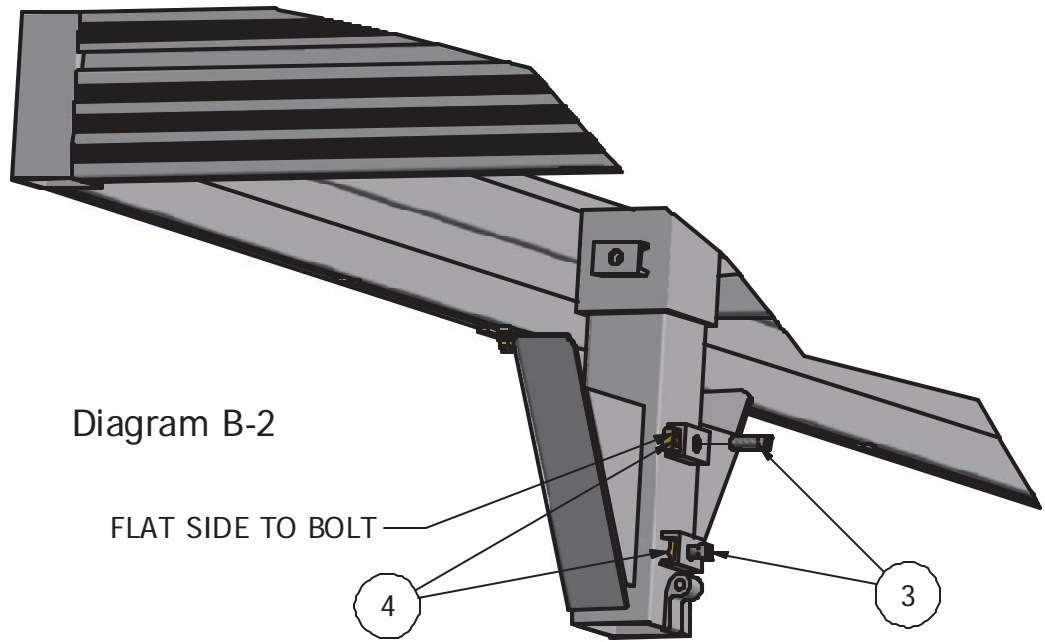

Diagram B-1



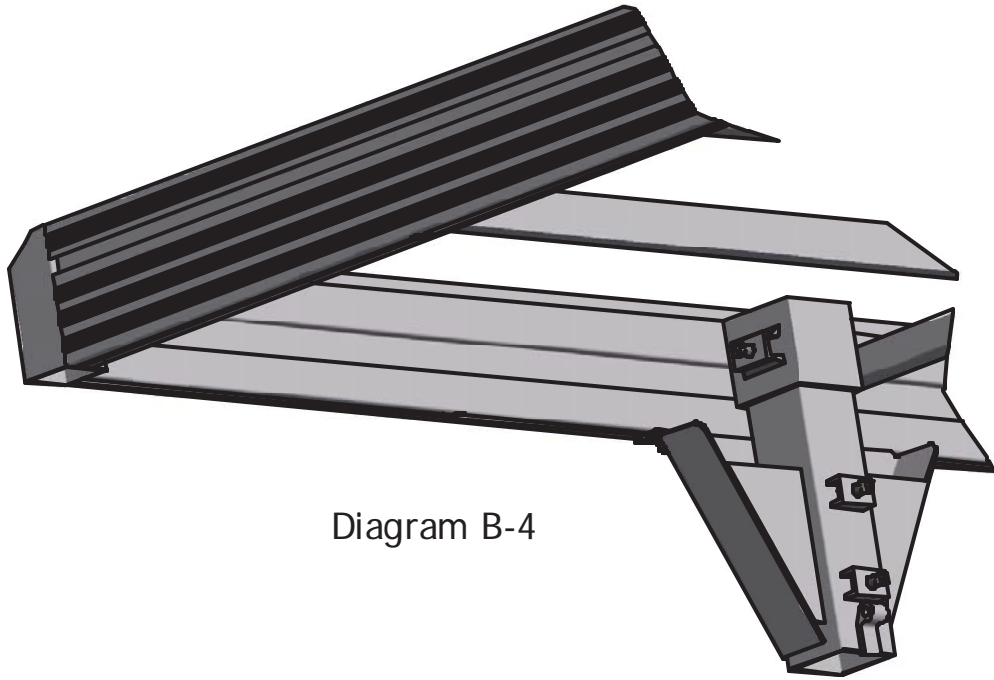

Diagram B-4

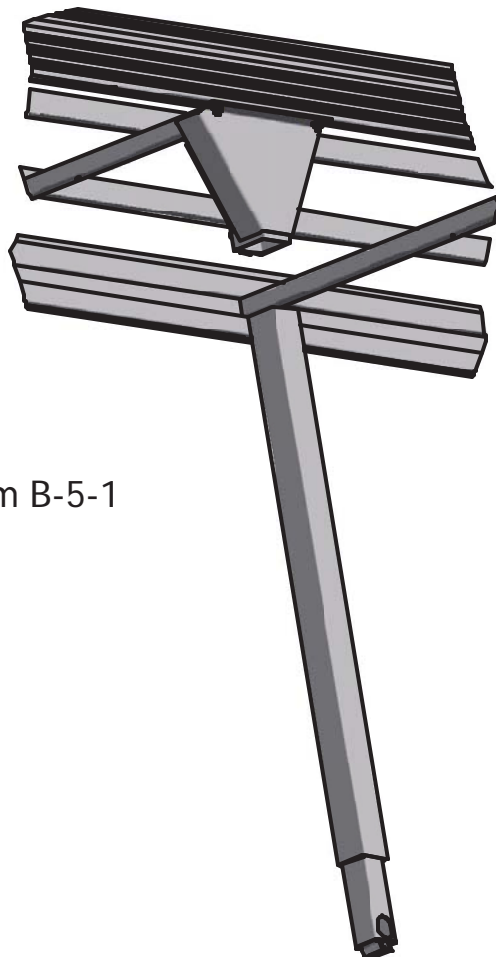

Diagram B-5-1

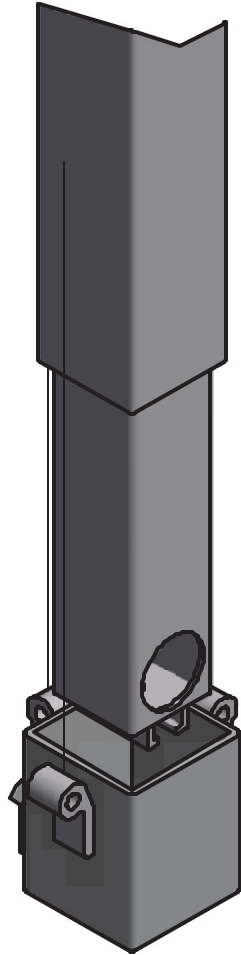

Diagram B-5-2

- 22) Put 3" washer onto stub axle, slide poly tire on, put another 3" washer on, install stub axle and tire into screw leg with tire to inside of dock until washer is close to screw leg (leave clearance so tire isn't tight). **Per diagram B-6, page 21.**
- 23) Install square nut into bottom of screw leg and install set bolt. Tighten with ½" wrench. **Per diagram B-7, page 21.**
- 24) Slide upper brace into lower brace, put ½" square nut into channel on brace (see **diagram H-1, page 22**) flat side of nut towards bolt head. Start bolt into nut and into tube slightly to hold nut in place, do not tighten at this time.
- 25) Install hinge end to single hinge on brace bracket on screw leg with 3/8" x 2 ½" bolt with flange nut. Install drilled end to cross tube of dock with 3/8" x 3" and flange nut. **Per diagram H-2 & H-3, page 23.**
- 26) Position brace. **Per diagram H-5, page 24.**
- 27) Tighten bolts at each end with 2-9/16" wrenches. Tighten set bolt with ½" wrench.
- 28) Repeat steps 13-27 for other side.
- 29) If this is only dock sections to be installed skip to step 43. *If hooking more sections together proceed to step 30.*
- 30) If adding additional dock sections, lay additional frame up against end of first dock frame. **Per diagram B-8, page 25.**
- 31) Put 2 carriage bolts in bottom raceway of side rail on the opposite end of wheel end, slide towards corner pocket. Also put 2 carriage bolts into bottom of raceway of side rail on dock that is being added on, having bolts slid toward lake end dock. **Per diagram C, page 26.**
- 32) Install add-on bracket into corner post of dock, align carriage bolts with slots as setting into place and attach flange nuts to bolts. **Per diagram C-1.**
- 33) Tighten flange nuts with 9/16" wrench.
- 34) Put square nuts into channels on add-on bracket. Start set bolts into nuts only enough to keep nuts in place at this time. **Per diagram C-2, page 26.**
- 35) Install square nut into foot pad and start set bolt. **Per diagram C-3, page 27.**
- 36) Install dock leg**into foot pad and tighten set bolt with ½" wrench.
- 37) Install dock leg with foot pad into add on bracket (can either block dock up if necessary to get leg into desired height or put flush for now and set height once dock is in place. **Per diagram C-4, page 27.**
- 38) Tighten one set bolt with ½" wrench (second one can be tightened up now or once dock is put in place).
- 39) Repeat 31-38 for second add-on bracket.
- 40) Install square nuts into Rapid Link bracket and thread set bolts in far enough to keep nuts in place. **Per diagram D, page 28.**
- 41) Install Rapid Link bracket onto dock end rail (keep bracket towards outside edge of dock as possible). **Per diagram D-1, page 28.**

NOTE:
(FOR L SECTION AND DOUBLE L SECTION WHEEL GOES TO INSIDE)

Diagram B-6

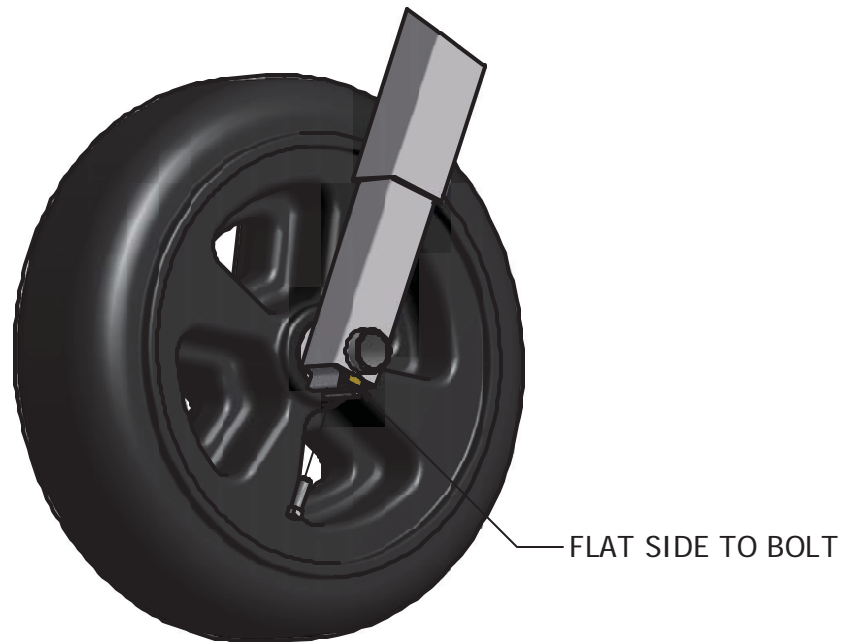
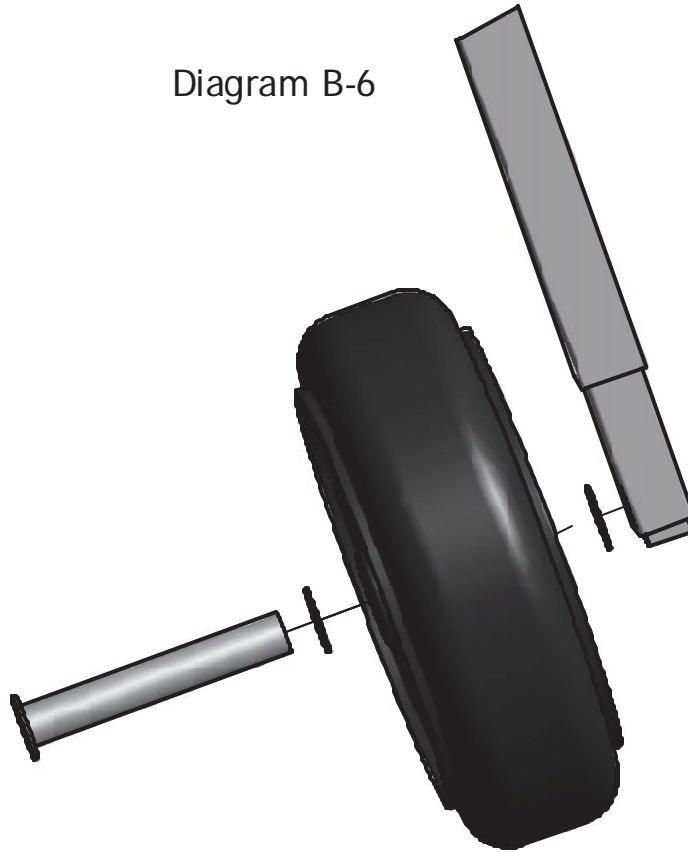

Diagram B-7

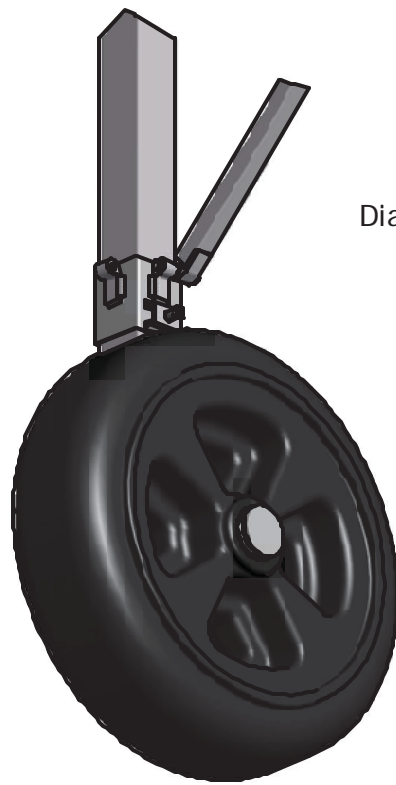

Diagram H

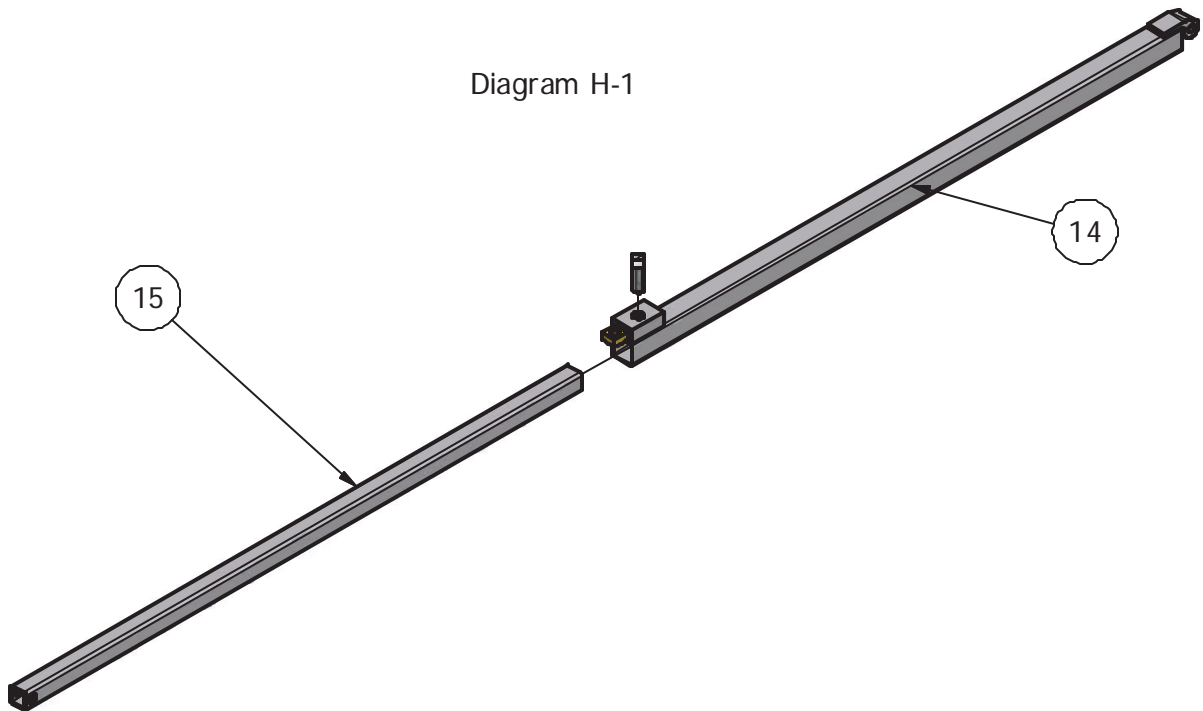

Diagram H-1

Diagram H-2

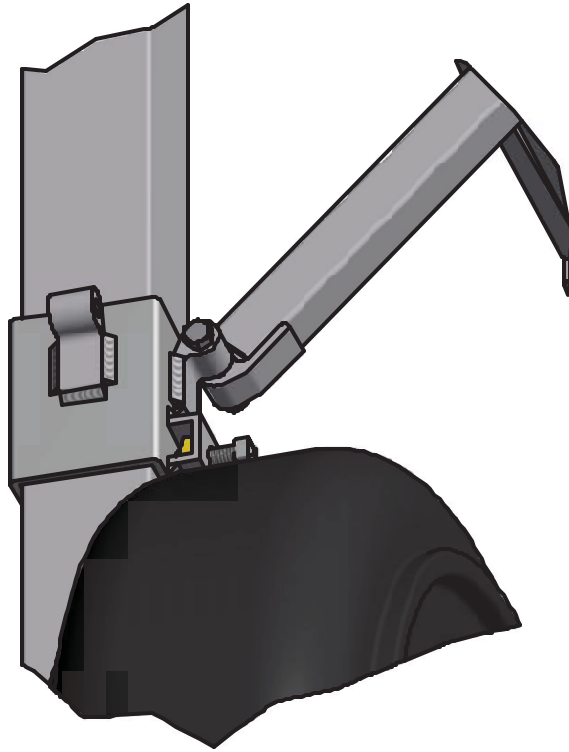

Diagram H-3

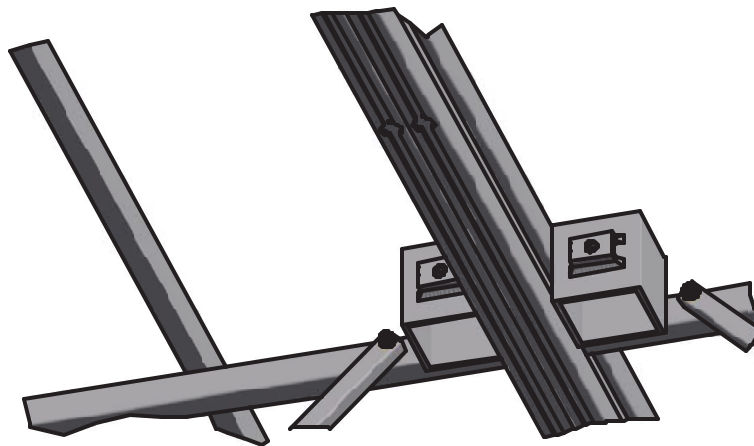

Diagram H-5

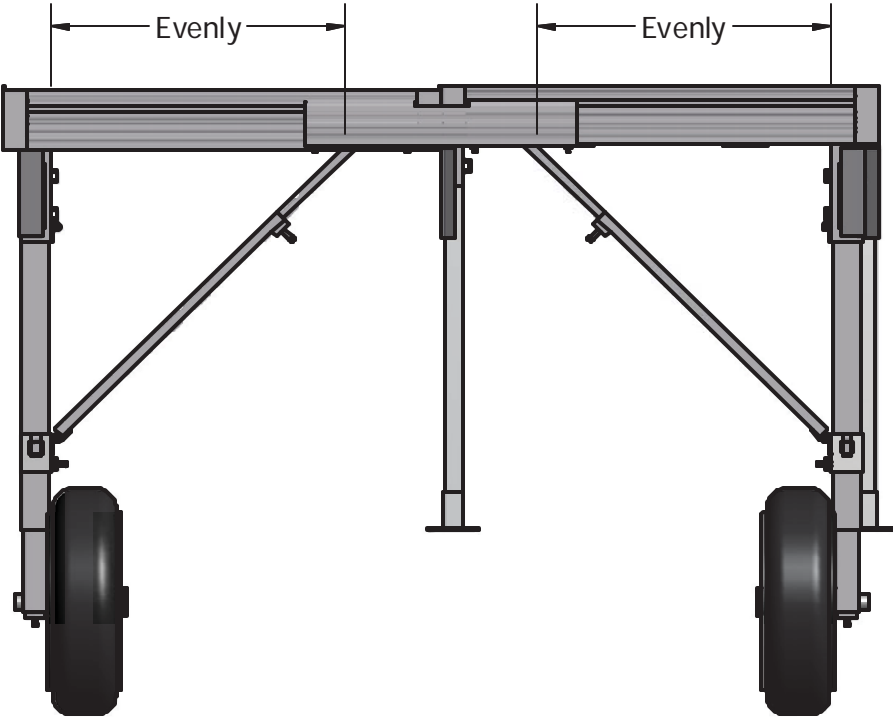
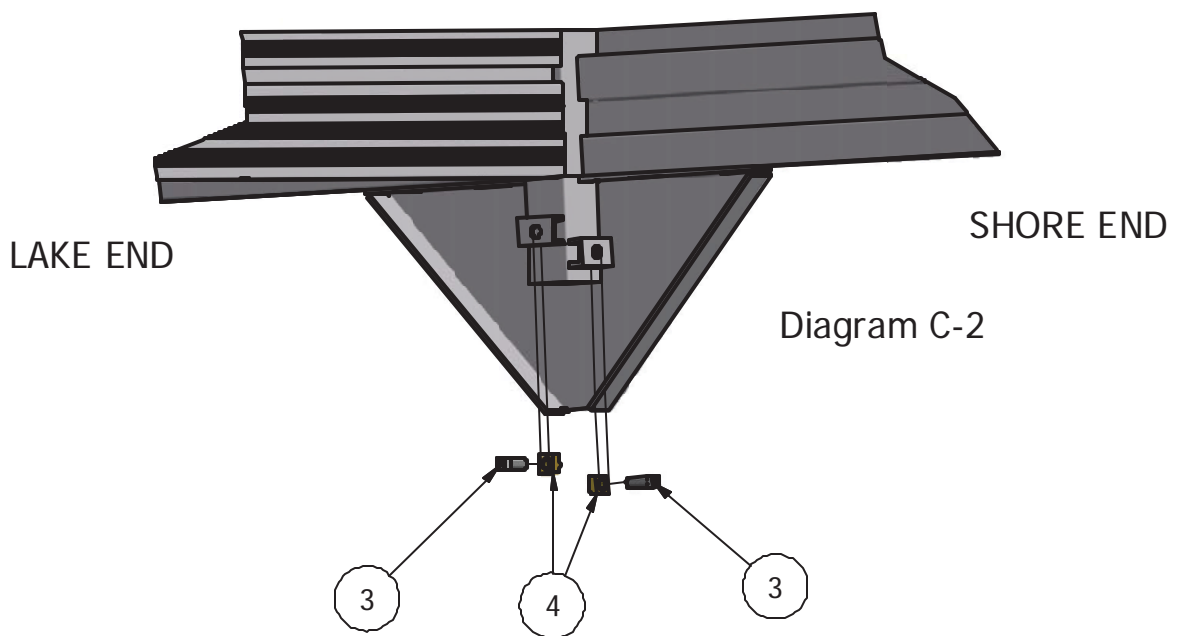
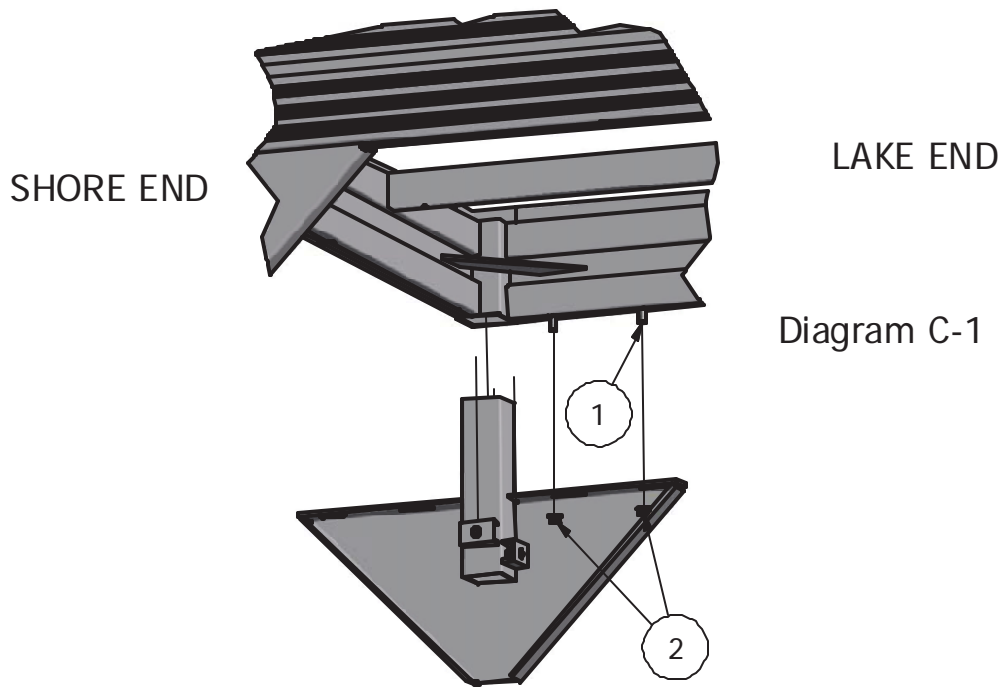



Diagram C



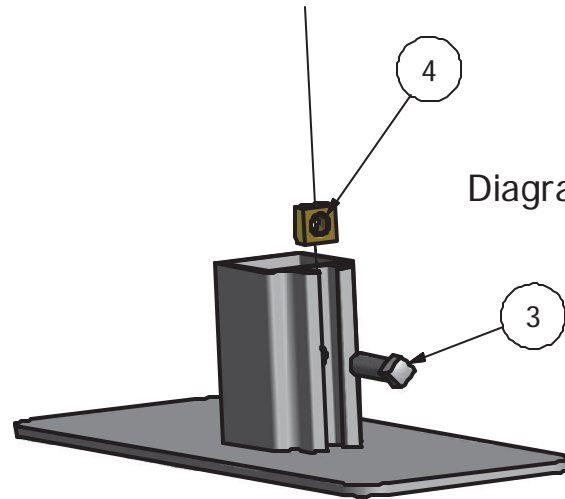

Diagram C-3

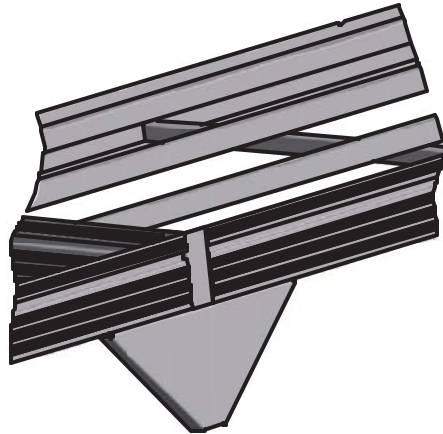
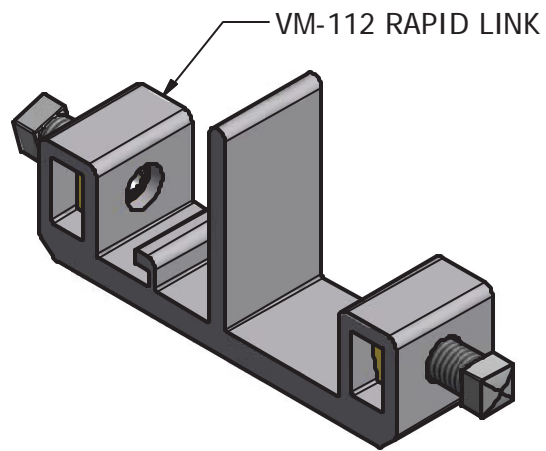

Diagram C-4



NOTE:
ONLY USED IF HOOKING
UP MULTIPLE DOCKS.

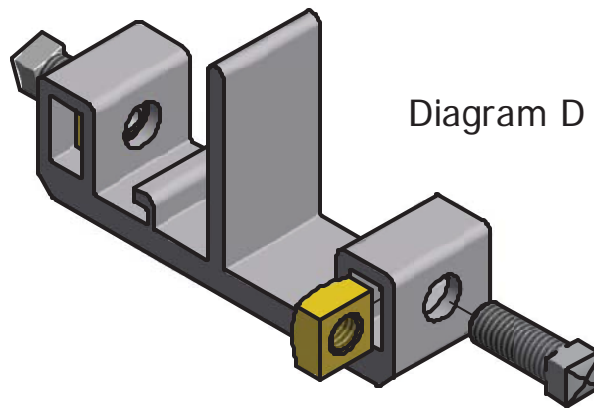
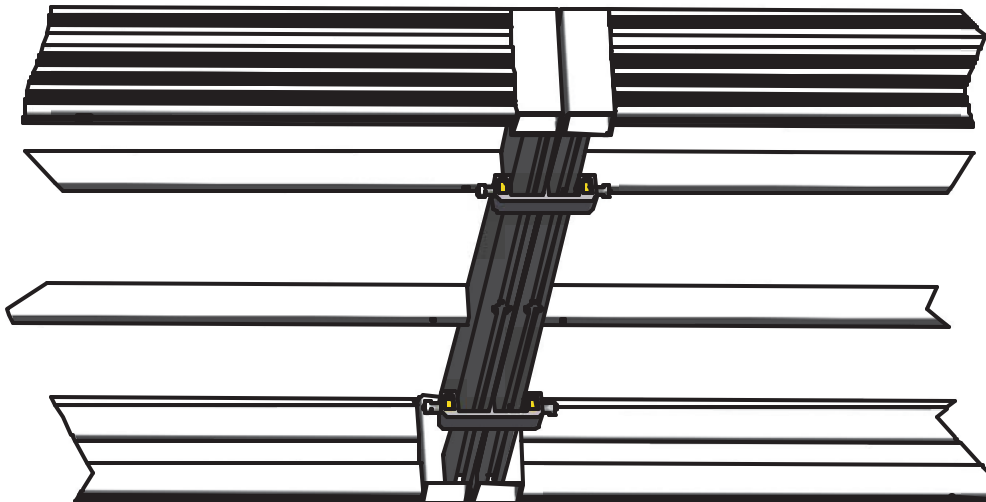

Diagram D-1



- 42)** Tighten set bolts in Rapid Link bracket to dock with ½" wrench.
- 43)** Repeat steps 40-42 for second bracket.
- 44)** Dock can be tipped over and rolled into water at this time or next frame can be added on first (depending on dock layout going with and lot condition) before rolling in.
- 45)** Roll dock set up into place desired. Using tape measure and level set screw legs (using 15/16" wrench or socket) and add-on legs to desired height; level dock frames and tighten all set bolts to legs.
- 46)** Recheck all hardware to make sure they are in place and tight.
- 47)** Dock panels can now be installed. Some panels may need to be notched for dock legs depending on dock leg position.
- 48)** Install vinyl caps onto screw legs if above deck. ***
- 49)** If dock legs for add-on legs are above deck install vinyl caps on these also. ***

***keep in mind screw legs are shipped fully compressed, will need to screw out some to have adjustment for water fluctuation.**

*****dock leg sold separately, length needs to be determined at installation site.***

******if dock legs are mounted under deck caps won't be used***