

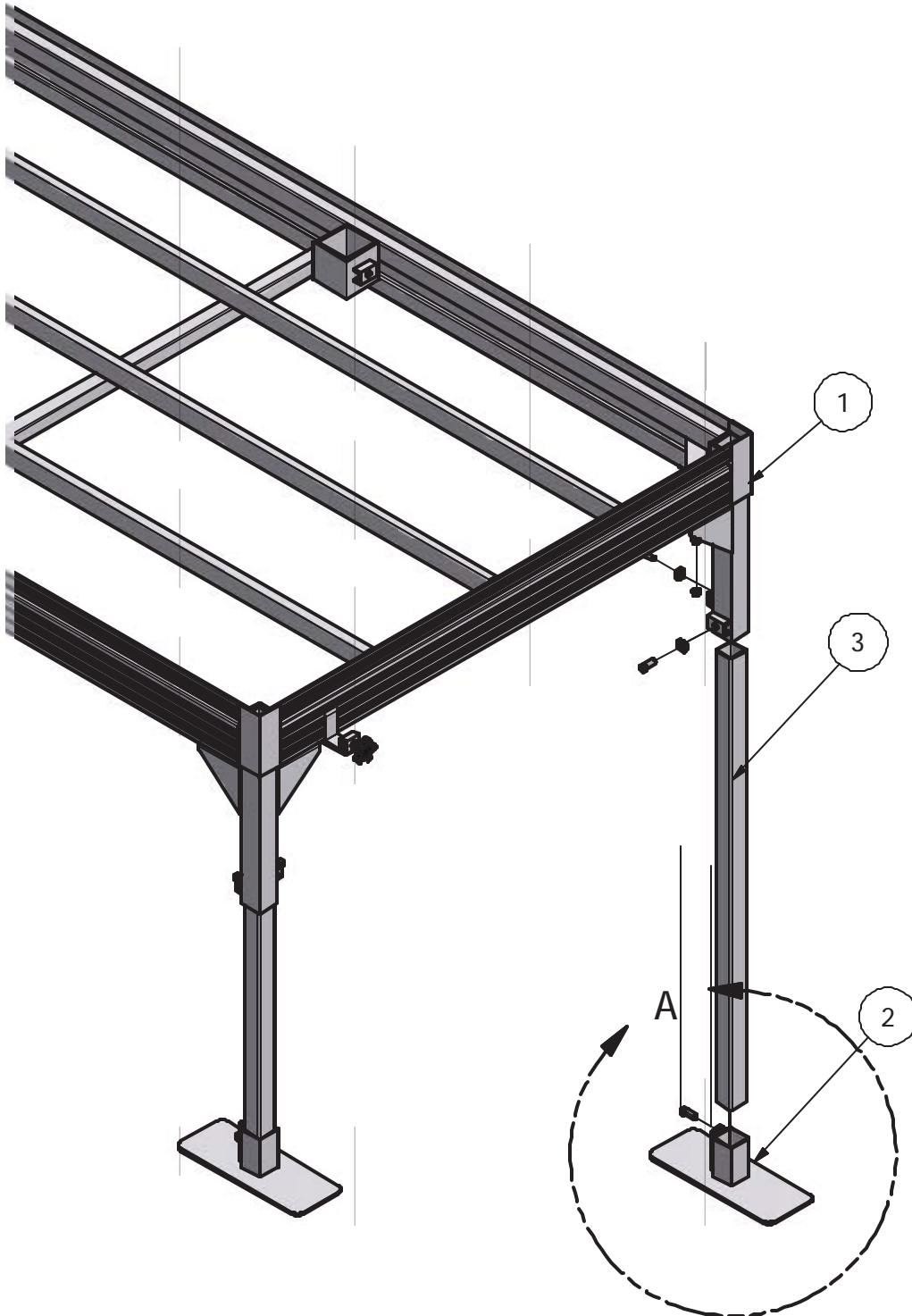

## Standing Dock Leg

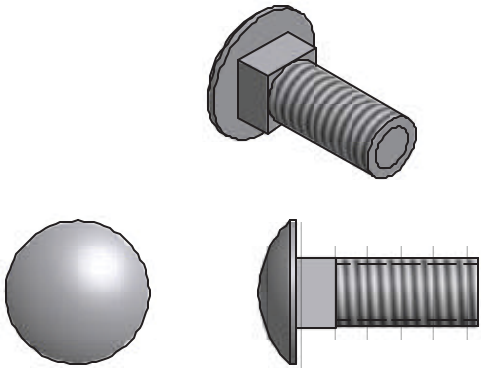

7



3/8 X 1 S.S. CARRIDGE BOLT (4 REQ'D)

5

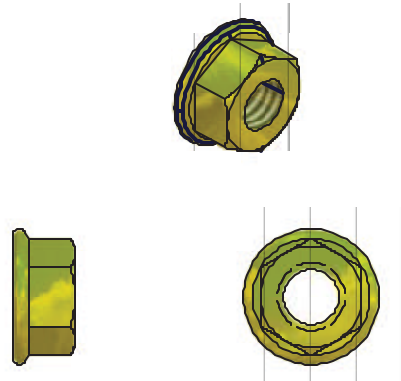

3/8 FLANGE NUT (4 REQ'D)

4

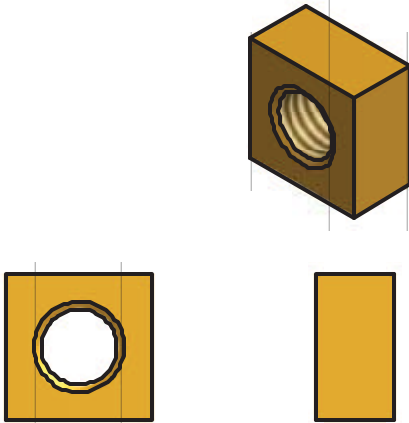

1/2 SQ. NUT BRASS (10 REQ'D)

6

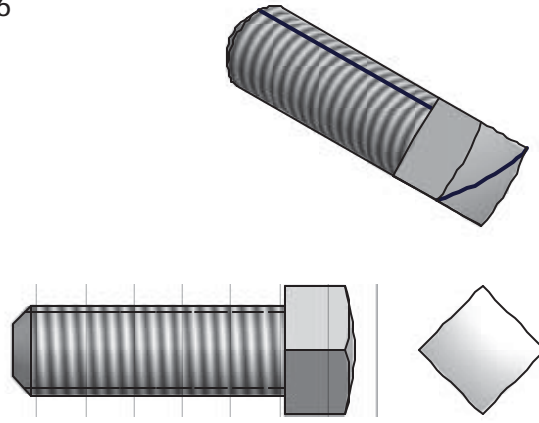

1/2 X 1 1/4 SQ. HEAD BOLT ( 8 REQ'D)

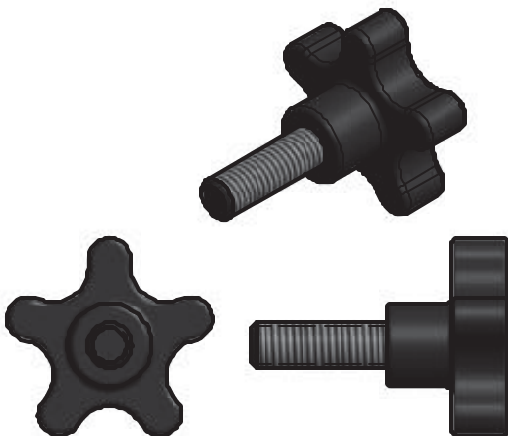

5 PRONG KNOB (2 REQ'D)

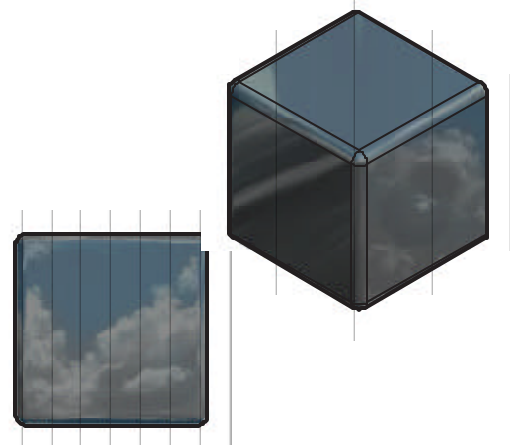

LEG CAPS (2 REQ'D)

**To insure your safety while assembling your Voyager product:**

- Fully read and understand the assembly instructions
- Do not assemble this product if items are missing or damaged
- Wear protective gloves, clothing and eye wear when assembling this product

❖ *Note: You may need assistance when turning dock over and also when installing dock into the water.*

**Installation procedure**

The following tools will be needed: 1/2" wrench, 9/16" wrench, tape measure, cut off saw, level.

1. For ease of installation set dock frame upside down on a flat surface.
2. Insert head of 2- carriage bolts into raceway on the underside of dock rail, one on side rail and one on end rail. **Per diagram A.**
3. Put square nuts into bracket and start bolts in nut to keep in place. **Per diagram B.**
4. Take foot pad and slide square nut into place and start bolt to keep in place. **Per diagram C.**
5. Slide bracket into corner post of dock, slide carriage bolts into bracket slots and attach flange nuts. **Per diagram D.**
6. Take 9/16" wrench and tighten flange nuts.
7. Slide dock leg into dock bracket\* (you will need to do following to figure out dock leg length: determine if dock legs are mounted below deck or sticking above deck and with how much above, measure water depths using the lengths of docks being installed and leg location if docks go side by side or off to the side and height of dock frame to be out of the water).
8. Put foot pad onto leg and tighten set bolt with 1/2" wrench. **Per diagram E.**
9. Put leg to desired height using tape measure and tighten set bolts firmly to keep leg in place for dock installation using a 1/2" wrench.
10. Repeat steps 2-9 for second bracket.
11. If connecting multiple dock frames go to step 12. If last frame skip to step 14.
12. Take connector brackets\*\* slide square nuts into it and start set bolts in one nut and 5 prong knob in other nut (screw in enough to keep nuts in place). **Per diagram F.**

- 13)** Put bracket on dock frame in desired location and tighten set bolt with ½" wrench and leave 5 prong knob as is until next dock is put in place per dock instruction manual. **Per diagram F.**
- 14)** Dock can now be tipped over to upright position.
- 15)** Install dock frame into water, check dock height and level. When height and level are set tighten set bolts with ½" wrench.
- 16)** Check to make sure all hardware is in and tight.
- 17)** Dock panels can now be installed. Some panels may need to be notched for dock legs depending on dock leg position.
- 18)** If dock legs are installed above deck install caps to top of legs. \*\*\*

**\*dock leg not supplied in kit, sold separate.**

**\*\* Connector brackets are used for hooking another dock frame together with this one otherwise won't be used**

**\*\*\*if dock legs are mounted under deck caps won't be use**

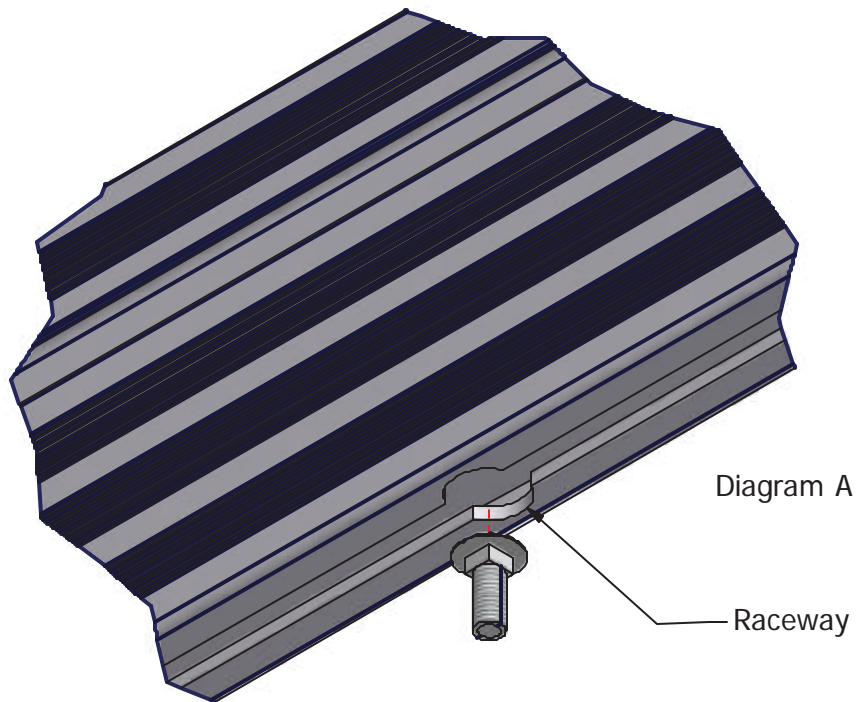

| PARTS LIST |     |                |                         |
|------------|-----|----------------|-------------------------|
| ITEM       | QTY | PART NUMBER    | DESCRIPTION             |
| 1          | 2   | VM-007         | LEG SOCKET ASM, [NS]    |
| 2          | 2   | VOY001-FOOTPAD | DETACHABLE FOOTPAD      |
| 3          | 10  | HD-00058       | 1/2 SQ_NUT BRASS        |
| 4          | 4   | HD-00056       | 3/8 FLANGE BRASS NUT    |
| 5          | 8   | HD-00060       | 1/2 X 1 1/4 SQ BOLT S/S |
| 6          | 4   | HD-00059       | 3/8 X 1 CAR S/S         |
| 7          | 2   | HD-00159       | 5 PRONG KNOB            |
| 8          | 2   | VM-112         | DOCK BRACKET            |

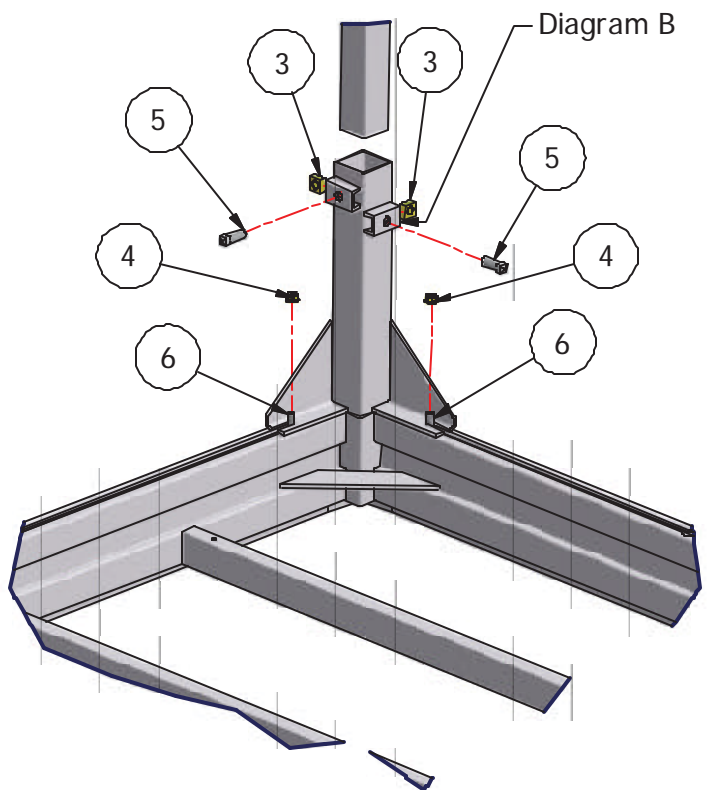
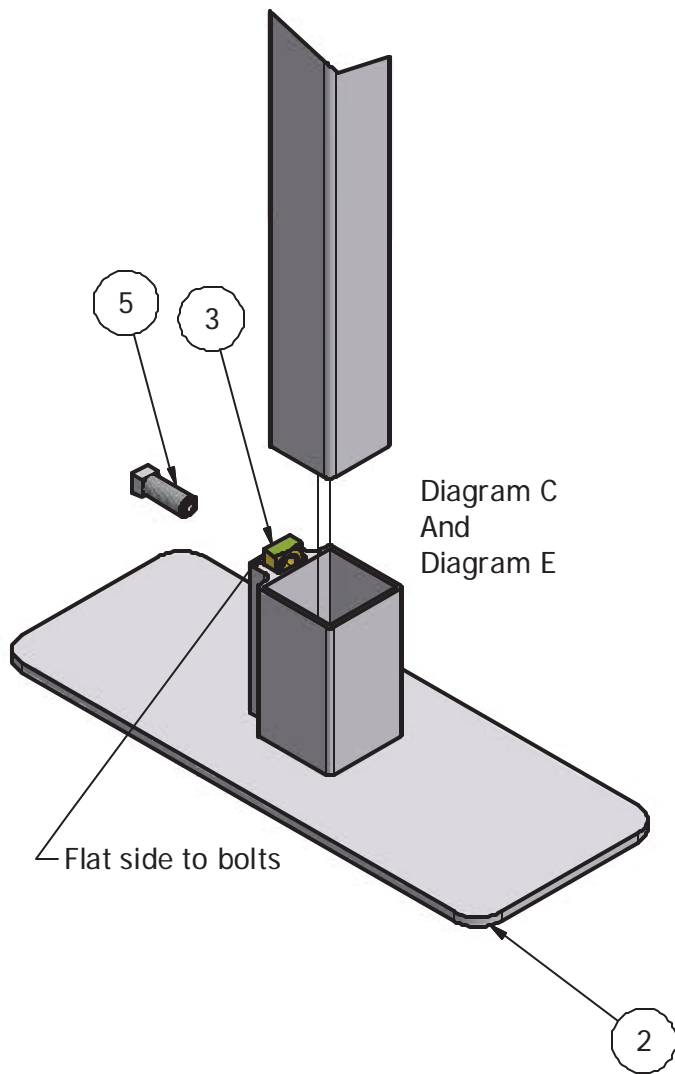

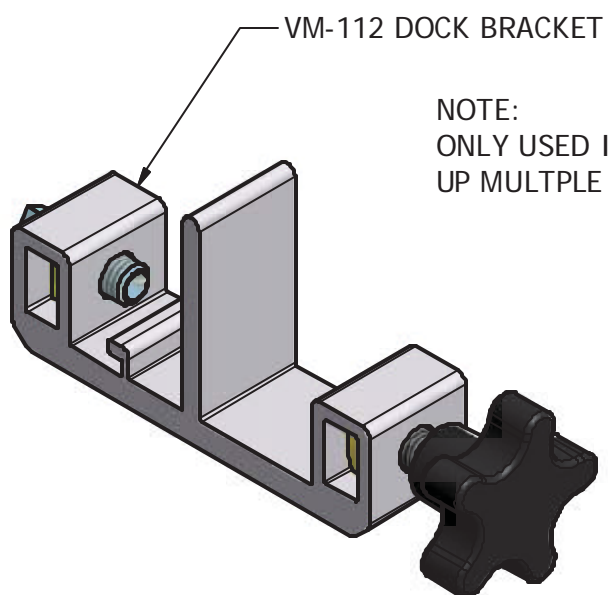
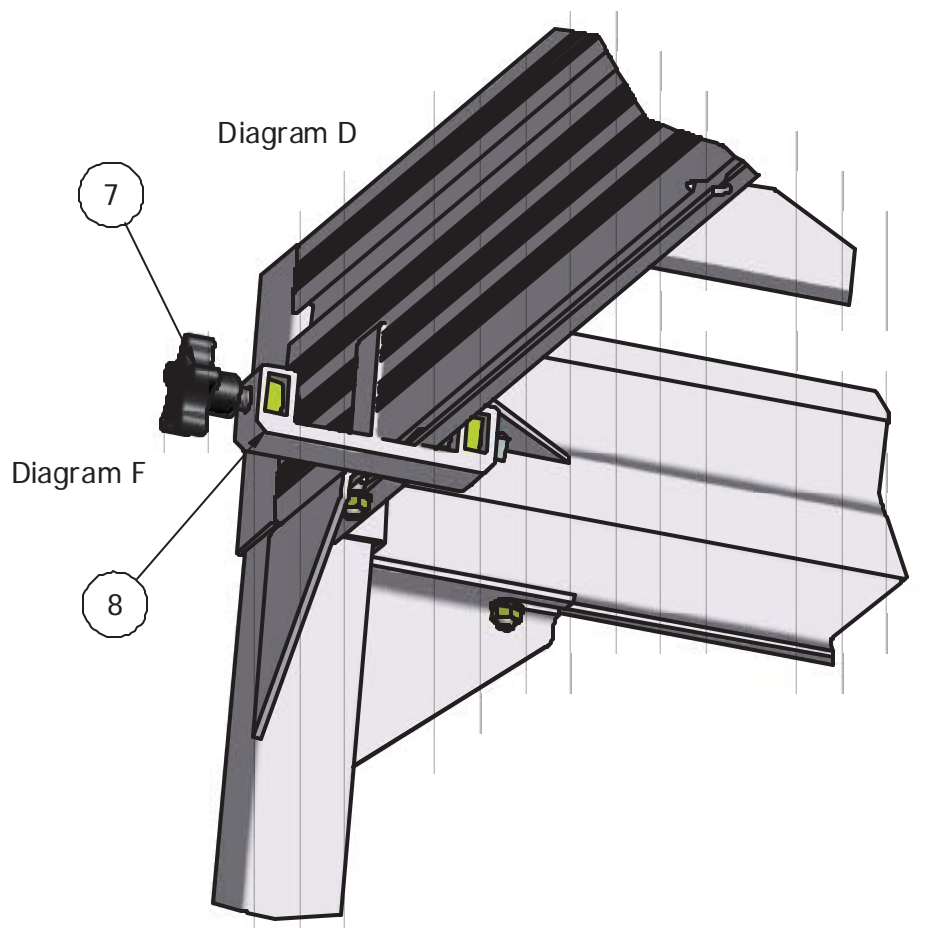

NOTE:  
ONLY USED IF HOOKING  
UP MULTIPLE DOCKS.