

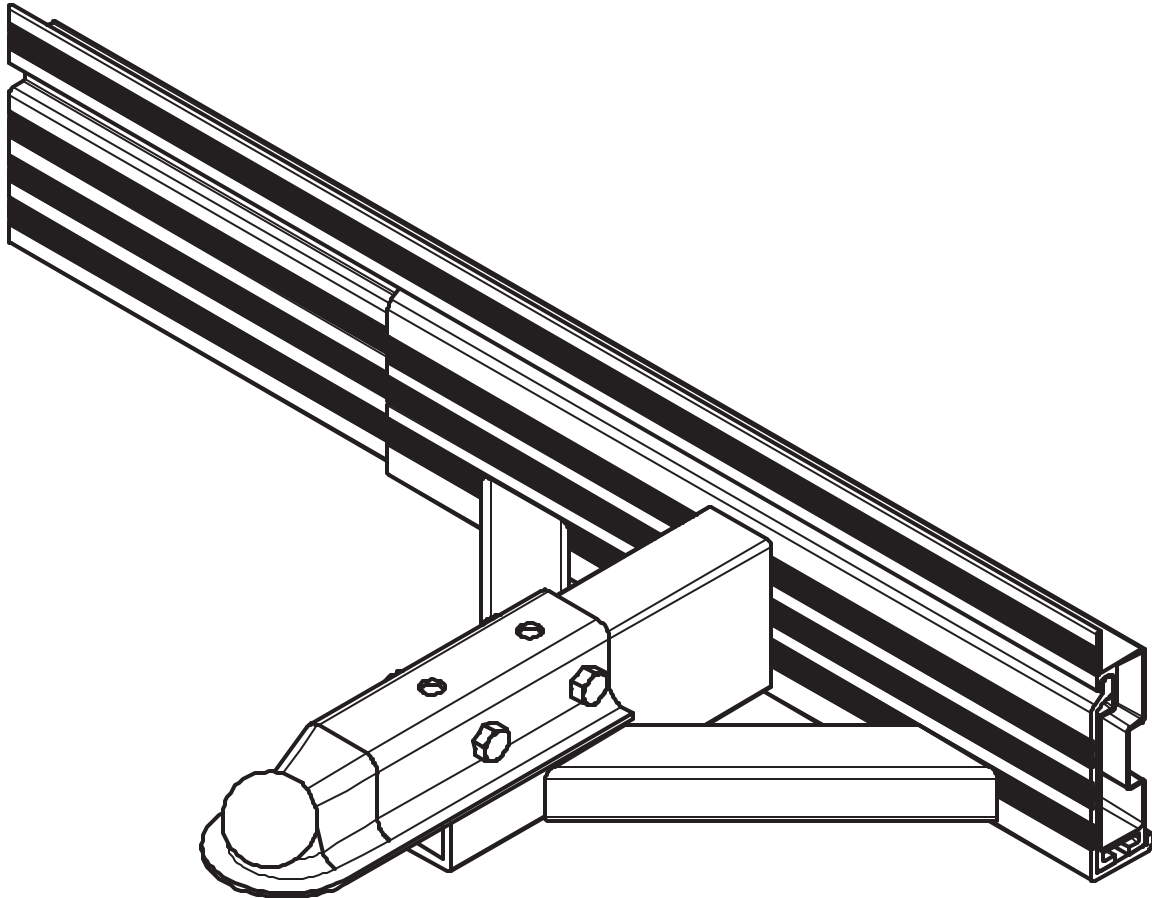

Tow Hitch

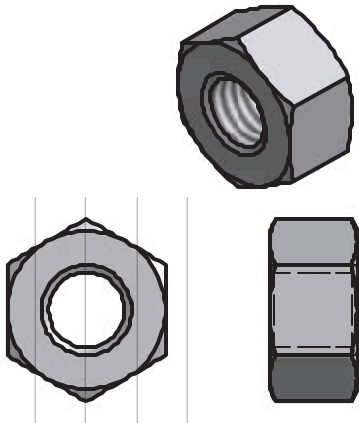

3



1/2 NYLOCK NUT (2 REQ'D)

2

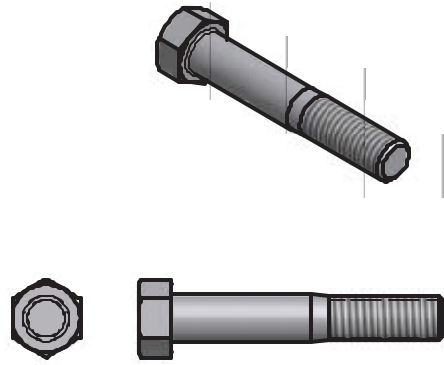

1/2 X 3 HEX BOLT (2 REQ'D)

5

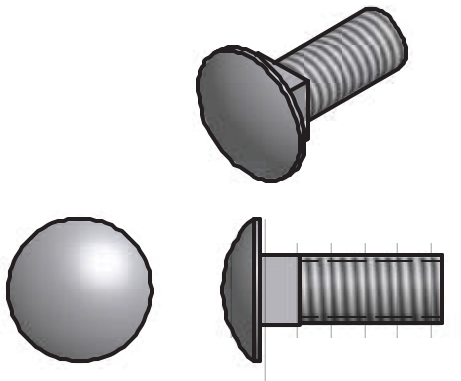

3/8 X 1" CAR SS BOLTS (2 REQ'D)

6

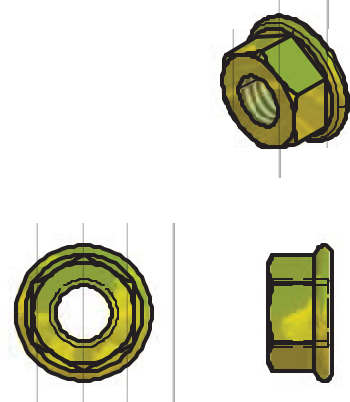

3/8 FLANGE NUTS BRASS (2 REQ'D)

To insure your safety while assembling your Voyager product:

- Fully read and understand the assembly instructions
- Do not assemble this product if items are missing or damaged
- Wear protective gloves, clothing and eye wear when assembling this product

Installation procedure

The following tools will be needed: 9/16" wrench & 2- 3/4" wrenches

1. Set coupler onto bracket **per diagram B** and put 2-1/2" bolts through coupler and bracket.
2. Thread nylock nuts onto bolts and use 3/4" wrenches to tighten up.
3. Insert head of carriage bolts into raceway on the underside of the dock rail on end of dock and slide one towards each side of the dock. **Per diagram A.**
4. Hook bracket into dock rail and put carriage bolts into bracket and attach flange nuts. **Per diagram C.**
5. Take 9/16" wrench and tighten flange nut.

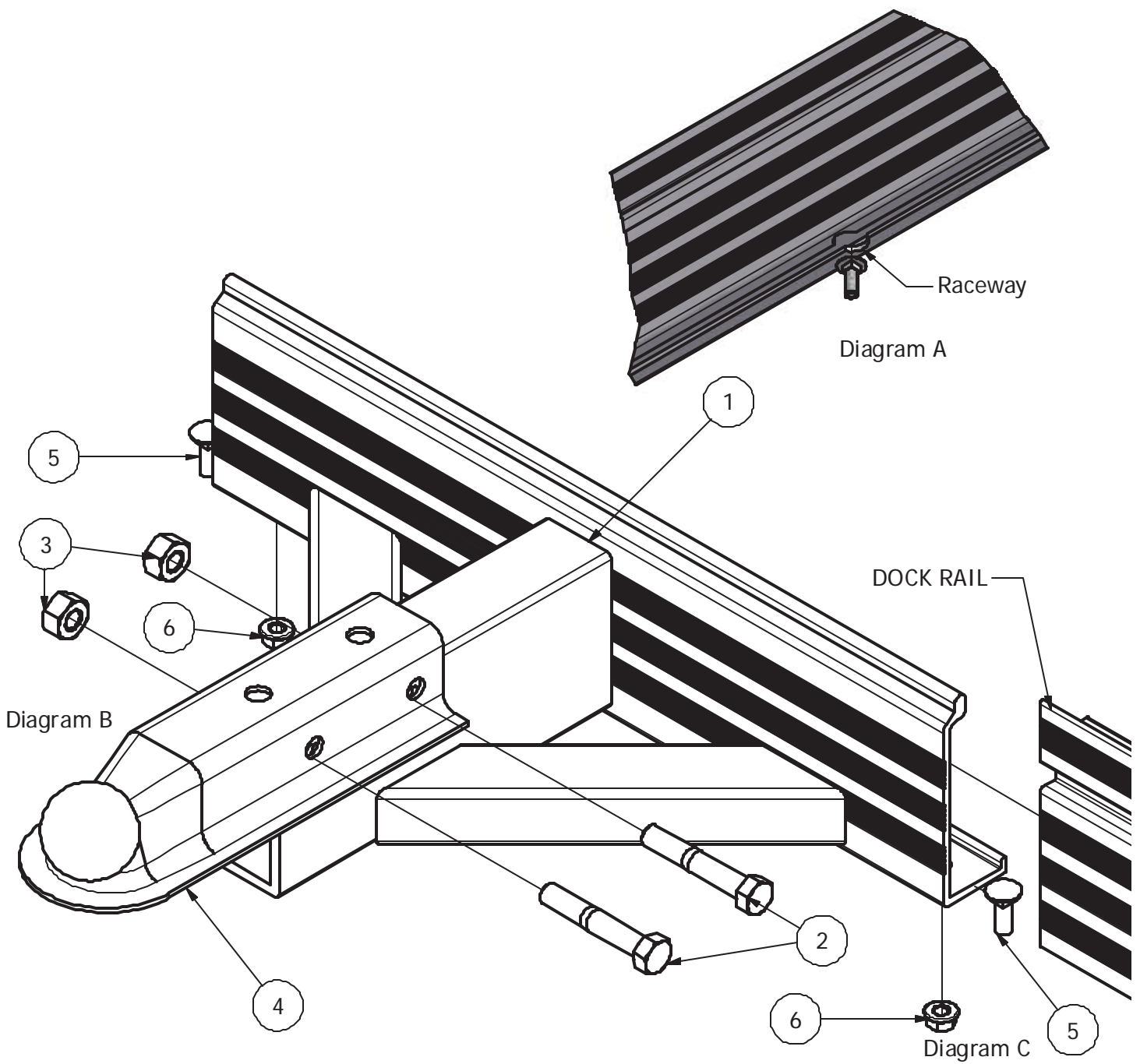

PARTS LIST			
ITEM	QTY	PART NUMBER	DESCRIPTION
1	1	VM-043-A	BRACKET
2	2	HD-00022	.500 X 3 HEX BOLT
3	2	HD-00003	.500 NYLOCK NUT
4	1	HD-00092	COUPLER 2" BALL
5	2	HD-00059	3-8 X 1 SS CAR
6	2	HD-00056	3/8 BRASS FLANGE NUT